

Wilkerson Manual In-Line Desiccant Dryers

Applications:

Manual air dryers are used to remove water vapor from compressed air systems, in applications such as paint spraying, laboratory instruments and small control air systems. Filtration for absorber type dryers is important to protect the desiccant bed from contamination. Cleaner incoming air will result in better performance, longer life and fewer service problems. To regenerate silica gel desiccant, it must be heated to at least 350°F for approximately 3 hours or until color has changed from pink to blue. Allow desiccant to cool to room temperature before pouring back into unit bowl.



An after-filter should be placed downstream from the desiccant dryer to ensure solid contaminants such as desiccant dust do not migrate downstream.

Features:

- 1.64 lb. bowl
- will dry up to 4400 standard cubic feet of air
- desiccant; good for approximately 440 minutes at maximum continuous air flow before regeneration is required
- silica gel changes from blue to pink to indicate the need to replace or regenerate the desiccant
- slotted bowl guard for visual detection of color change
- no electrical connection necessary
- provides atmospheric dew point of -45°F with dry desiccant at **100 PSIG** and **70°F**
- maximum operating conditions:
 - transparent bowl: **150 PSIG** (10 bar) and **125°F** (52°C)
 - metal bowl: **150 PSIG** (10 bar) and **150°F** (66°C)

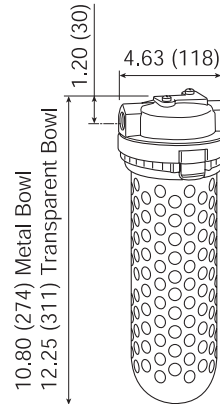

with metal bowl

Size	Flow (SCFM)	With Transparent Bowl		With Metal Bowl	
		Part #	Price/E	Part #	Price/E
1/4"	10	X03-02	\$348.50	X03-02MB	\$450.70

Wilkerson Dial Air Regulators

Dial-air regulators feature a transparent, pressure-calibrated, non-rising adjustment dial for quick adjustment of secondary pressure. The full reduced pressure range can be dialed in less than 270° of dial rotation. This feature is particularly advantageous if secondary pressure must be changed frequently. Dial air regulators can be mounted in any position so dial face is always visible. All dial-air units have a slight constant air bleed.

Features:

- 0-160 PSI adjusting range
- balanced valve design
- relieving type
- non-rising pressure adjusting dial
- piston operated
- two 1/4" NPT gauge ports standard on models without gauge, one 1/4" NPT gauge port standard on models with gauge - can be used for additional outlet ports.
- models supplied without gauge use a GC230 gauge
- maximum operating pressure: **300 PSIG** (20.7 bar)
- temperature range: **32°F** to **150°F** (0°C to 65.5°C)

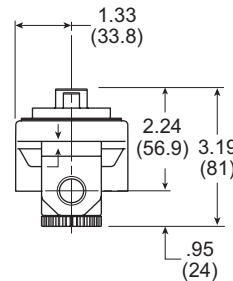

Size	Flow (SCFM)	With Gauge		Without Gauge	
		Part #	Price/E	Part #	Price/E
1/4"	117	R21-02RG	\$220.45	R21-02R	\$199.75
3/8"	180	R21-03RG	220.45	R21-03R	199.75
1/2"	195	R21-04RG	220.45	R21-04R	199.75
3/4"	220	R21-06RG	220.45	R21-06R	199.75

See pages 229-231 for regulator accessories.



FRL's are designed for air service only, unless otherwise indicated.

SCFM ratings at 100 PSIG inlet pressure.