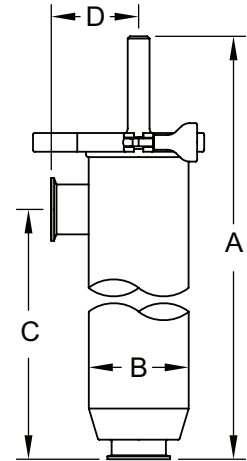

Side-Entry Filter / Strainer - *BSCCQ***Features:**

- side entry units ship standard with the following: spring, end cap with handle, distributor cap, clamp gasket, 1/4" perforated back-up tube, body and squeeze clamp
- serviceable without removing from the line
- must be a vertically mounted to be 3A compliant
- Bevel seat, I-line and weld ends available, call Dixon Sanitary at 800.789.1718 for information
- 1/8" perforated back-up tube available, must specify when ordering (not 3A)

Size	Dimensions				316L Stainless Steel Part #	Price/E
	A	B	C	D		
1½"	41.90"	4.00"	35.00"	3.50"	<i>BSCCQ3-R150</i>	\$3227.80
2"	41.90"	4.00"	35.00"	3.50"	<i>BSCCQ3-R200</i>	3227.80
3"	41.90"	4.50"	35.00"	3.75"	<i>BSCCQ3-R300</i>	3975.20