

M-12917

1

| CATALOG NUMBER | BODY COLOR | GOTCHA RING COLOR CODE | NPT HUB SIZE | CORD DIA. RANGE | Ø A (OVERALL) | (B) 4 | C | Ø D (THROAT DIA.) | *E ACROSS CORNERS | *E ACROSS FLATS |
|----------------|---------------|------------------------|--------------|-----------------------|---------------|-------------|------------|-------------------|-------------------|-----------------|
| SHC1046 | CAST ALUMINUM | WHITE | 1" | .88-1.00 [22.2-25.4] | 2.31 [58.7] | 1.70 [43.2] | .66 [16.8] | 1.02 [25.9] | 2.28 [57.9] | 2.00 [50.8] |
| SHC1047 | CAST ALUMINUM | WHITE | 1" | 1.00-1.13 [25.4-28.6] | 2.31 [58.7] | 1.70 [43.2] | .66 [16.8] | 1.02 [25.9] | 2.28 [57.9] | 2.00 [50.8] |
| SHC1048 | CAST ALUMINUM | WHITE | 1" | 1.13-1.25 [28.6-31.7] | 2.31 [58.7] | 1.70 [43.2] | .66 [16.8] | 1.02 [25.9] | 2.28 [57.9] | 2.00 [50.8] |
| SHC1049 | CAST ALUMINUM | WHITE | 1" | 1.25-1.38 [31.7-34.9] | 2.31 [58.7] | 1.70 [43.2] | .66 [16.8] | 1.02 [25.9] | 2.28 [57.9] | 2.00 [50.8] |
| SHC1050 | CAST ALUMINUM | WHITE | 1 1/4" | .75-.88 [19.0-22.2] | 2.31 [58.7] | 1.70 [43.2] | .73 [18.5] | 1.27 [32.3] | 2.44 [62.0] | 2.15 [54.6] |
| SHC1051 | CAST ALUMINUM | WHITE | 1 1/4" | .88-1.00 [22.2-25.4] | 2.31 [58.7] | 1.70 [43.2] | .73 [18.5] | 1.27 [32.3] | 2.44 [62.0] | 2.15 [54.6] |
| SHC1052 | CAST ALUMINUM | WHITE | 1 1/4" | 1.00-1.13 [25.4-28.6] | 2.31 [58.7] | 1.70 [43.2] | .73 [18.5] | 1.27 [32.3] | 2.44 [62.0] | 2.15 [54.6] |
| SHC1053 | CAST ALUMINUM | WHITE | 1 1/4" | 1.13-1.25 [28.6-31.7] | 2.31 [58.7] | 1.70 [43.2] | .73 [18.5] | 1.27 [32.3] | 2.44 [62.0] | 2.15 [54.6] |
| SHC1054 | CAST ALUMINUM | WHITE | 1 1/4" | 1.25-1.38 [31.7-34.9] | 2.31 [58.7] | 1.70 [43.2] | .73 [18.5] | 1.27 [32.3] | 2.44 [62.0] | 2.15 [54.6] |
| SHC1055 | CAST ALUMINUM | WHITE | 1 1/2" | .75-.88 [19.0-22.2] | 2.31 [58.7] | 1.70 [43.2] | .75 [19.1] | 1.39 [35.3] | 2.28 [57.9] | 2.11 [53.6] |
| SHC1056 | CAST ALUMINUM | WHITE | 1 1/2" | .88-1.00 [22.2-25.4] | 2.31 [58.7] | 1.70 [43.2] | .75 [19.1] | 1.39 [35.3] | 2.28 [57.9] | 2.11 [53.6] |
| SHC1057 | CAST ALUMINUM | WHITE | 1 1/2" | 1.00-1.13 [25.4-28.6] | 2.31 [58.7] | 1.70 [43.2] | .75 [19.1] | 1.39 [35.3] | 2.28 [57.9] | 2.11 [53.6] |
| SHC1058 | CAST ALUMINUM | WHITE | 1 1/2" | 1.13-1.25 [28.6-31.7] | 2.31 [58.7] | 1.70 [43.2] | .75 [19.1] | 1.39 [35.3] | 2.28 [57.9] | 2.11 [53.6] |
| SHC1059 | CAST ALUMINUM | WHITE | 1 1/2" | 1.25-1.38 [31.7-34.9] | 2.31 [58.7] | 1.70 [43.2] | .75 [19.1] | 1.39 [35.3] | 2.28 [57.9] | 2.11 [53.6] |

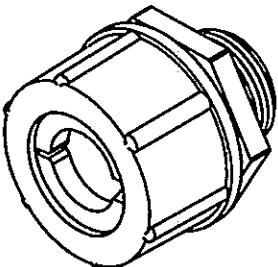

CATALOG NO. SHC1046
(NOT SHOWN TO SCALE)

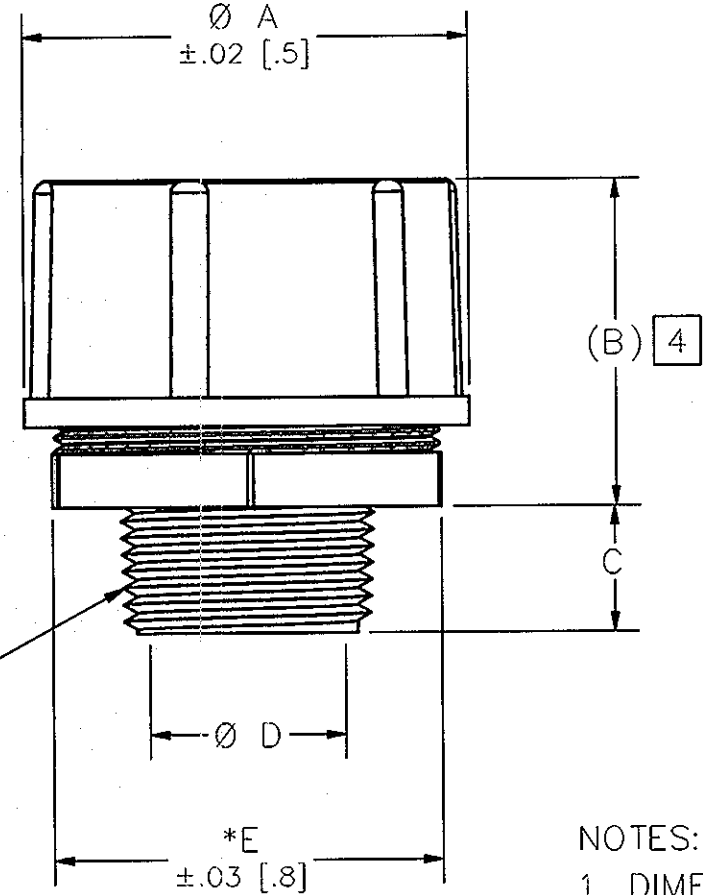

NPT HUB SIZE

- NOTES:
- DIMENSIONS ARE IN INCHES [MM].
 - LOCKNUT PURCHASED SEPARATELY.
 - BUSHING COATED WITH AMBER PETROLEUM JELLY.
 - 4 REFERENCE ONLY, DIMENSION MAY VARY.

| LIST OF PARTS | | |
|-------------------------------|----------------|------------|
| DESCRIPTION | MATERIAL | FINISH |
| CORD CONNECTOR BODY STR. MALE | CAST ALUMINUM | |
| BUSHING | BLACK NEOPRENE | SEE NOTE 3 |
| GOTCHA RING | NYLON | SEE TABLE |
| NUT | ALUMINUM | |

DIMENSION SHEET FOR CAT. NO. SEE TABLE

REPAIRABLE NON-REPAIRABLE

B

M-12917

1

| | | | |
|-----|-------------------------------|-----|----------|
| 1 | INITIAL RELEASE PER DCN 21189 | DDL | 05/06/15 |
| REV | DESCRIPTION | APP | DATE |

THE DESIGN AND DIMENSIONS OF THE PRODUCT SHOWN ON THIS DRAWING ARE SUBJECT TO CHANGE WITHOUT NOTICE

TITLE
STRAIGHT ALUMINUM CORD CONNECTOR FORM 5

| | | | | | | | |
|---------------------------------------|---------------|---------------|--|--|-----|---------|----------|
| TOLERANCES UNLESS OTHERWISE SPECIFIED | | | | WIRING DEVICE-KELLEMS HUBBELL INCORPORATED SHELTON, CT | | | |
| .XX = ± .01 | .XXX = ± .005 | ANGLES = ± 2' | | DR. BY | SR | APP. BY | |
| | | | | TR. BY | | SCALE | 1:1 |
| | | | | CHK. BY | DDL | DATE | 05/06/15 |