

FRAME	"C"	"L"	"AD"
800	13.82	3.82	4.13
850	14.32	4.32	4.63
900	14.82	4.82	5.13
950	15.32	5.32	5.63
1000	15.82	5.82	6.13
1050	16.32	6.32	6.63
1100	16.82	6.82	7.13
1150	17.32	7.32	7.63
1200	17.82	7.82	8.13

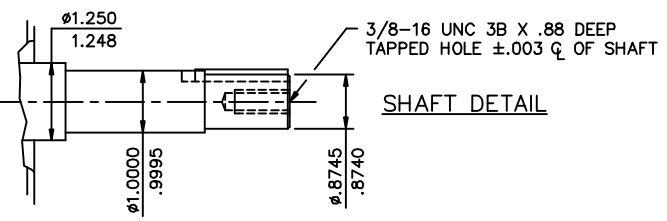

GASKETS THROUGHOUT
 MAXIMUM FACE RUNOUT TO BE .004 T.I.R.
 MAXIMUM PILOT ECCENTRICITY TO BE .004 T.I.R.
 PERMISSIBLE SHAFT RUNOUT TO BE .002 T.I.R.

		TOLERANCES UNLESS SPECIFIED		MARATHON ELECTRIC		DRAWN VV 08/30/07		
		DEC.	INCHES			CHK	YS 08/30/07	
		.X	±.1			APPD		
		.XX	±.03	TITLE		SCALE	1-2	
02	ADDED FLINGER WHEN REQ'D ISAAC 12-2578	GWS	6/11/12	OUTLINE- 180T FRAME		REF	035472	
01	SHAFT HOLE WAS 3A x .56 DEEP, WARNING NOTE ADDED	JD	05/26/11	DRIP PROOF- RIGID		FMF	184TCDW7047	
NO.	REVISION	BY & DATE	CHK	ANG	MAT'L	PREV		
			ANG	±1/2'	FINISH			
THIS DRAWING IN DESIGN AND DETAIL IS OUR PROPERTY AND MUST NOT BE USED EXCEPT IN CONNECTION WITH OUR WORK ALL RIGHTS OF DESIGN AND INVENTION ARE RESERVED THIS IS AN ELECTRONICALLY GENERATED DOCUMENT - DO NOT SCALE THIS PRINT				RFP	CAD FILE	035557	SIZE	DRAWING NO.
				DIST			B	035557
								REV.
								02