



### Climax Metal Products Company

8141 Tyler Boulevard  
Mentor, Ohio 44060  
USA

Toll free: 800-542-6552

Phone: 440-585-0300

Fax: 800-860-5553

Email: [sales@climaxmetal.com](mailto:sales@climaxmetal.com)

Website: [www.climaxmetal.com](http://www.climaxmetal.com)

## ITEM # 2ISCC-112-100KW, TWO-PIECE INDUSTRY STANDARD CLAMPING COUPLINGS W/KEYWAY 2ISCC-SERIES

Black Oxide Steel Two-Piece Industry Standard Clamping Coupling with Keyway. High axial load & torque capacity. Does not mar the shaft.



[Drawing](#) | [Specifications](#) |

### Drawing

#### Dimensional Drawing

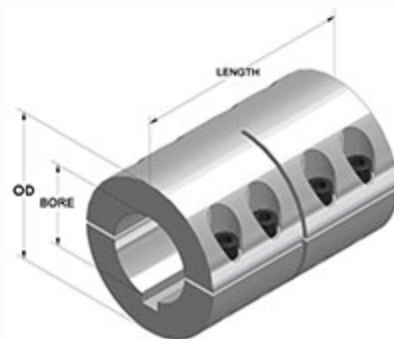

Two-Piece Industry Standard Clamping Coupling with Keyway

### Specifications

<b>Bore</b>	1 1/8 in
<b>2nd Bore</b>	1 in
<b>OD</b>	1 7/8 in
<b>Length</b>	3 1/8 in
<b>Style</b>	Two-Piece Clamp
<b>Keyway Size</b>	1/4 x 1/8 in
<b>Material</b>	Steel, ASTM A108
<b>Finish</b>	Black Oxide
<b>Clamp Screw</b>	Hex Socket Cap Screw, 3A Thread, Steel, ASTM A574: 1/4-28 x 5/8
<b>Recessed Screw</b>	No
<b>Approximate Weight</b>	33.00 oz
<b>UPC Code</b>	044861043066
<b>Downloads</b>	<a href="#">Catalog Page</a>

### Competitor Part Number

### Alternate Part Number

1451082  
 175X10034  
 2APH9  
 2ISCC112100KW  
 4171526  
 4594930  
 SPC1816F  
 SPC-18-16-F