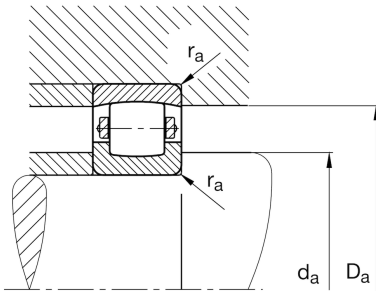
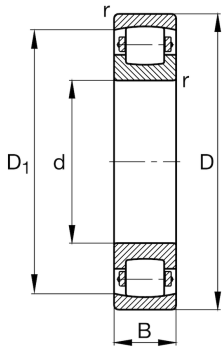
**FAG****20206-TVP-C3**

Barrel roller bearing

Schaeffler ID:  
0167017470030Barrel roller bearings 202, main  
dimensions to DIN 635-1

## Technical information

**Main Dimensions & Performance Data**

d	1,181 in	Bore diameter
D	2,441 in	Outside diameter
B	0,63 in	Width
$C_r$	6,294,964 lbf	Basic dynamic load rating, radial
$C_{0r}$	6,407,374 lbf	Basic static load rating, radial
$C_{ur}$	663,219 lbf	Fatigue load limit, radial
$n_G$	10.800 1/min	Limiting speed
	0,45 lbs	Weight

**Mounting dimensions**

$d_{a \min}$	1,402 in	Minimum diameter shaft shoulder
$D_{a \max}$	2,22 in	Maximum diameter of housing shoulder
$r_{a \max}$	0,039 in	Maximum recess radius

**Dimensions**

$r_{\min}$	0,039 in	Minimum chamfer dimension
$D_1$	2,087 in	Bore diameter outer ring

**Temperature range**

$T_{\min}$	-22 °F	Operating temperature min.
$T_{\max}$	248 °F	Operating temperature max.