

FAG

**20230-MB-C3**

Barrel roller bearing

Schaeffler ID:  
0190001700030

Barrel roller bearing 202...-MB

## Technical information

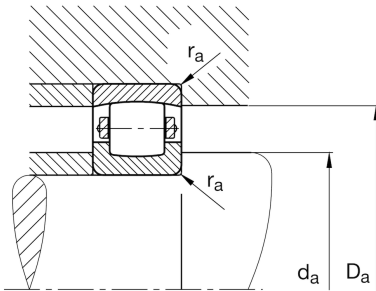
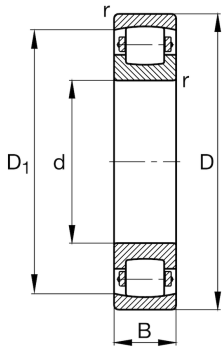
**Main Dimensions & Performance Data**

d	5,906 in	Bore diameter
D	10,63 in	Outside diameter
B	1,772 in	Width
$C_r$	96.672,662 lbf	Basic dynamic load rating, radial
$C_{0r}$	137.140,288 lbf	Basic static load rating, radial
$C_{ur}$	12.589,928 lbf	Fatigue load limit, radial
$n_G$	2.850 1/min	Limiting speed
	25,574 lbs	Weight

**Mounting dimensions**

$d_{a \min}$	6,457 in	Minimum diameter shaft shoulder
$D_{a \max}$	10,079 in	Maximum diameter of housing shoulder
$r_{a \max}$	0,098 in	Maximum recess radius

**Dimensions**

$r_{\min}$	0,118 in	Minimum chamfer dimension
$D_1$	9,394 in	Bore diameter outer ring

**Temperature range**

$T_{\min}$	-22 °F	Operating temperature min.
$T_{\max}$	392 °F	Operating temperature max.