

FAG

20310-TVP-C3

Barrel roller bearing

Schaeffler ID:
0190140900030

Barrel roller bearings 203, main
dimensions to DIN 635-1

Technical information

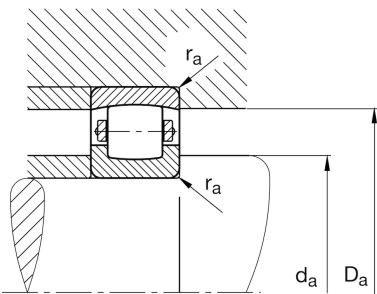
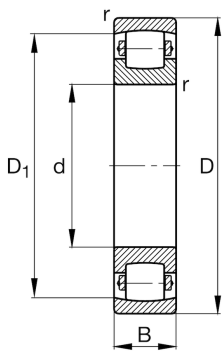

Main Dimensions & Performance Data

d	1,969 in	Bore diameter
D	4,331 in	Outside diameter
B	1,063 in	Width
C _r	24.280,576 lbf	Basic dynamic load rating, radial
C _{0r}	26.528,777 lbf	Basic static load rating, radial
C _{ur}	2.383,094 lbf	Fatigue load limit, radial
n _G	5.800 1/min	Limiting speed
	2,888 lbs	Weight

Mounting dimensions

d _{a min}	2,402 in	Minimum diameter shaft shoulder
D _{a max}	3,898 in	Maximum diameter of housing shoulder
r _{a max}	0,079 in	Maximum recess radius

Dimensions

r _{min}	0,079 in	Minimum chamfer dimension
D ₁	3,717 in	Bore diameter outer ring

Temperature range

T _{min}	-22 °F	Operating temperature min.
T _{max}	248 °F	Operating temperature max.