

FAG

23944-S-K-MB-C4

Spherical Roller Bearing

Schaeffler ID:
0190418700040

Spherical roller bearings 239..-K, main dimensions to DIN 635-2, with tapered bore, taper 1:12

Technical information

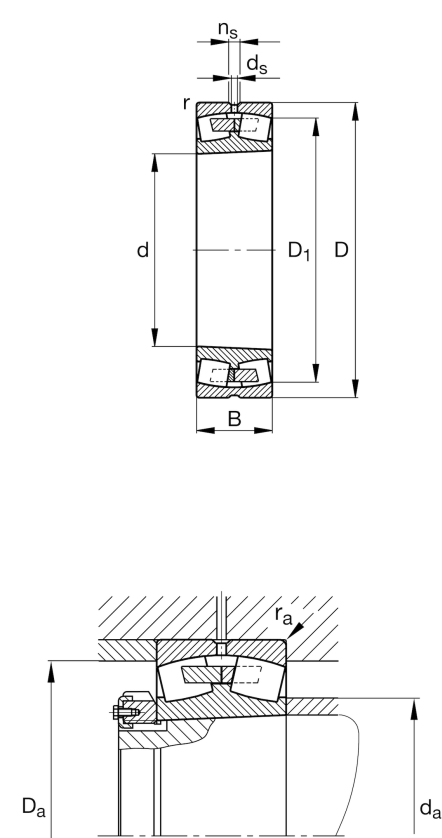

Main Dimensions & Performance Data

d	8,661 in	Bore diameter
D	11,811 in	Outside diameter
B	2,362 in	Width
C _r	137.140,288 lbf	Basic dynamic load rating, radial
C _{0r}	278.776,978 lbf	Basic static load rating, radial
C _{ur}	16.636,691 lbf	Fatigue load limit, radial
n _G	2.600 1/min	Limiting speed
n _{gr}	1.460 1/min	Reference speed
	26,477 lbs	Weight

Mounting dimensions

d _{a min}	9,063 in	Minimum diameter shaft shoulder
D _{a max}	11,409 in	Maximum diameter of housing shoulder
r _{a max}	0,083 in	Maximum recess radius
d _{a max}	9,488 in	Maximum diameter of shaft shoulder
d _{b min}	9,055 in	Minimum cavity diameter of the sleeve
B _{a min}	0,354 in	Minimum cavity width of the sleeve

Dimensions

r _{min}	0,083 in	Minimum chamfer dimension
D ₁	10,921 in	Bore diameter outer ring
d _s	0,248 in	Diameter lubrication hole
n _s	0,48 in	Width of lubricating groove

Temperature range

T _{min}	-22 °F	Operating temperature min.
T _{max}	392 °F	Operating temperature max.

Calculation factors		
e	0,18	Limiting value of Fa/Fr for the applicability of diff. Values of factors X and Y
Y ₁	3,76	Dynamic axial load factor
Y ₂	5,59	Dynamic axial load factor
Y ₀	3,67	Static axial load factor
Additional information		
	H3944	Adapter sleeve
	AH3944	Withdrawal sleeve