

FAG

3203-BD-XL-2Z-C3

Angular contact ball bearing

Schaeffler ID:
0816585320030Angular contact ball bearing 32..-BD-
XL-2Z, double row, X-life, shields, steel
sheet metal cage

X-life

Technical information

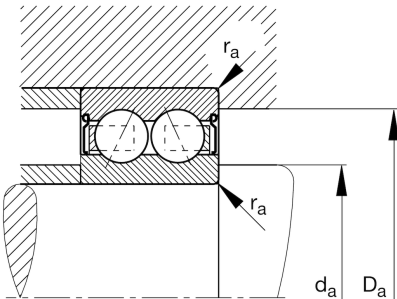
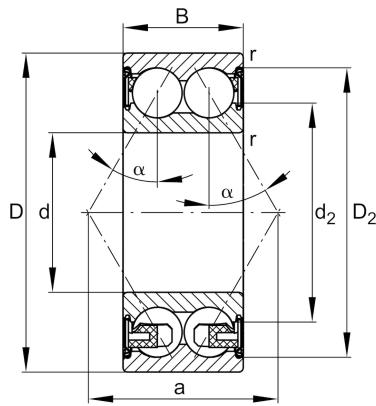

Main Dimensions & Performance Data

d	0,669 in	Bore diameter
D	1,575 in	Outside diameter
B	0,689 in	Width
C_r	3.484,712 lbf	Basic dynamic load rating, radial
C_{0r}	2.135,791 lbf	Basic static load rating, radial
C_{ur}	148,381 lbf	Fatigue load limit, radial
n_G	14.600 1/min	Limiting speed
n_{gr}	16.600 1/min	Reference speed
	0,214 lbs	Weight

Mounting dimensions

$d_{a \min}$	0,835 in	Minimum diameter shaft shoulder
$D_{a \max}$	1,409 in	Maximum diameter of housing shoulder
$r_{a \max}$	0,024 in	Maximum fillet radius

Dimensions

r_{\min}	0,024 in	Minimum chamfer dimension
D_2	1,421 in	Caliber diameter outer ring
d_2	0,961 in	Caliber diameter inner ring
a	0,925 in	Distance between the apexes of the pressure cones
α	30 °	Contact angle

Temperature range

T_{\min}	-4 °F	Operating temperature min.
T_{\max}	248 °F	Operating temperature max.