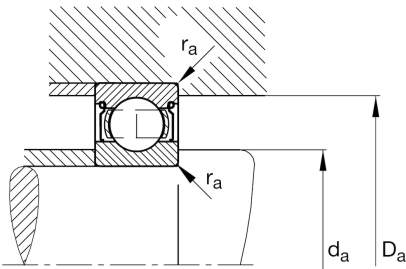
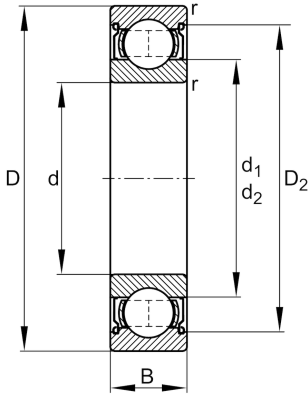

**FAG****6007-Z**

Deep groove ball bearing

Schaeffler ID:
0167175030000Deep groove ball bearing 60...-Z, single
row, shield, steel sheet metal cage

Technical information

**Main Dimensions & Performance Data**

d	1,378 in	Bore diameter
D	2,441 in	Outside diameter
B	0,551 in	Width
C_r	3.821,942 lbf	Basic dynamic load rating, radial
C_{0r}	2.315,647 lbf	Basic static load rating, radial
C_{ur}	125,899 lbf	Fatigue load limit, radial
n_G	16.100 1/min	Limiting speed
n_{gr}	11.700 1/min	Reference speed
	0,326 lbs	{Weight}

Mounting dimensions

$d_{a \min}$	1,559 in	Minimum diameter shaft shoulder
$D_{a \max}$	2,26 in	Maximum diameter of housing shoulder
$r_{a \max}$	0,039 in	Maximum fillet radius

Dimensions

r_{\min}	0,039 in	Minimum chamfer dimension
D_2	2,181 in	Caliber diameter outer ring
d_1	1,701 in	Shoulder diameter inner ring

Temperature range

T_{\min}	-22 °F	Operating temperature min.
T_{\max}	248 °F	Operating temperature max.

Calculation factors

f_0	14,9	Calculation factor
-------	------	--------------------