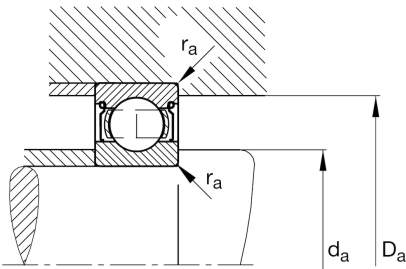
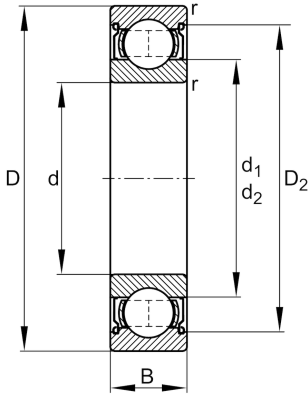

**FAG****6017-Z**

Deep groove ball bearing

Schaeffler ID:
0167182590000Deep groove ball bearing 60...-Z, single
row, shield, steel sheet metal cage

Technical information

**Main Dimensions & Performance Data**

d	3,346 in	Bore diameter
D	5,118 in	Outside diameter
B	0,866 in	Width
C_r	11.915,468 lbf	Basic dynamic load rating, radial
C_{0r}	9.667,266 lbf	Basic static load rating, radial
C_{ur}	562,05 lbf	Fatigue load limit, radial
n_G	7.100 1/min	Limiting speed
n_{gr}	5.800 1/min	Reference speed
	1,918 lbs	{Weight}

Mounting dimensions

$d_{a \min}$	3,583 in	Minimum diameter shaft shoulder
$D_{a \max}$	4,882 in	Maximum diameter of housing shoulder
$r_{a \max}$	0,039 in	Maximum fillet radius

Dimensions

r_{\min}	0,043 in	Minimum chamfer dimension
D_2	4,694 in	Caliber diameter outer ring
d_1	3,906 in	Shoulder diameter inner ring

Temperature range

T_{\min}	-22 °F	Operating temperature min.
T_{\max}	302 °F	Operating temperature max.

Calculation factors

f_0	15,7	Calculation factor
-------	------	--------------------