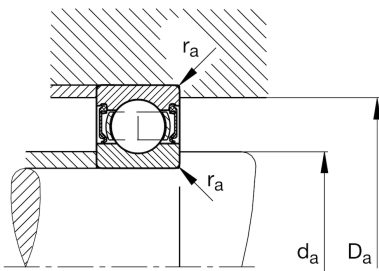
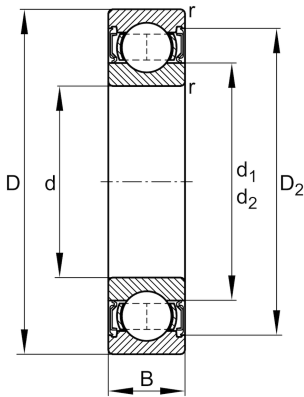

**FAG****6022-2RSR-C3**

Deep groove ball bearing

Schaeffler ID:
0190948170030Deep groove ball bearing 60..-2RSR,
single row, seals, steel sheet metal cage

Technical information

**Main Dimensions & Performance Data**

d	4,331 in	Bore diameter
D	6,693 in	Outside diameter
B	1,102 in	Width
C_r	19.109,712 lbf	Basic dynamic load rating, radial
C_{0r}	15.962,23 lbf	Basic static load rating, radial
C_{ur}	798,112 lbf	Fatigue load limit, radial
n_G	2.080 1/min	Limiting speed
	4,542 lbs	Weight

Mounting dimensions

$d_{a \min}$	4,677 in	Minimum diameter shaft shoulder
$D_{a \max}$	6,346 in	Maximum diameter of housing shoulder
$r_{a \max}$	0,079 in	Maximum fillet radius

Dimensions

r_{\min}	0,079 in	Minimum chamfer dimension
D_2	6,101 in	Caliber diameter outer ring
d_1	5,067 in	Shoulder diameter inner ring

Temperature range

T_{\min}	-4 °F	Operating temperature min.
T_{\max}	212 °F	Operating temperature max.

Calculation factors

f_0	15,7	Calculation factor
-------	------	--------------------