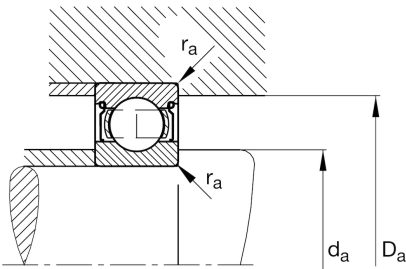
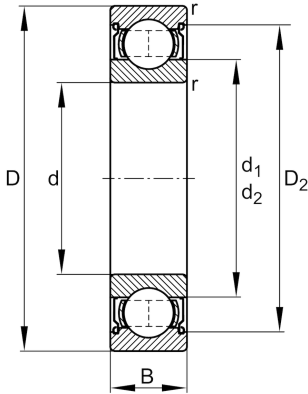

**FAG****6203-2Z-L038**

Deep groove ball bearing

Schaeffler ID:
0388964270000Deep groove ball bearing 62...-2Z, single
row, shields, steel sheet metal cage

Technical information

**Main Dimensions & Performance Data**

d	0,669 in	Bore diameter
D	1,575 in	Outside diameter
B	0,472 in	Width
C_r	2.270,683 lbf	Basic dynamic load rating, radial
C_{0r}	1.067,896 lbf	Basic static load rating, radial
C_{ur}	64,074 lbf	Fatigue load limit, radial
n_G	22.300 1/min	Limiting speed
n_{gr}	18.100 1/min	Reference speed
	2,328 oz	{Weight}

Mounting dimensions

$d_{a \min}$	0,835 in	Minimum diameter shaft shoulder
$D_{a \max}$	1,409 in	Maximum diameter of housing shoulder
$r_{a \max}$	0,024 in	Maximum fillet radius

Dimensions

r_{\min}	0,024 in	Minimum chamfer dimension
D_2	1,354 in	Caliber diameter outer ring
d_1	0,945 in	Shoulder diameter inner ring

Temperature range

T_{\min}	-4 °F	Operating temperature min.
T_{\max}	248 °F	Operating temperature max.

Calculation factors

f_0	13	Calculation factor
-------	----	--------------------