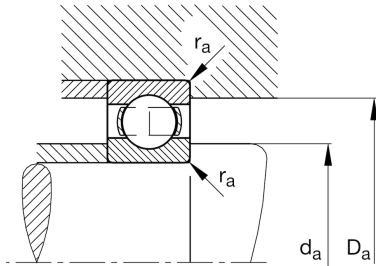
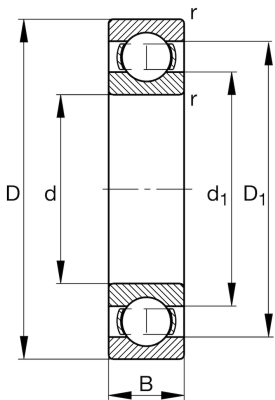

**FAG****6204-C3**

Deep groove ball bearing

Schaeffler ID:
0167196700030Deep groove ball bearing 62, single row,
steel sheet metal cage

Technical information

**Main Dimensions & Performance Data**

d	0,787 in	Bore diameter
D	1,85 in	Outside diameter
B	0,551 in	Width
C_r	3.057,554 lbf	Basic dynamic load rating, radial
C_{0r}	1.483,813 lbf	Basic static load rating, radial
C_{ur}	102,293 lbf	Fatigue load limit, radial
n_G	22.100 1/min	Limiting speed
n_{gr}	16.300 1/min	Reference speed
	3,656 oz	{Weight}

Mounting dimensions

$d_{a \min}$	1,008 in	Minimum diameter shaft shoulder
$D_{a \max}$	1,63 in	Maximum diameter of housing shoulder
$r_{a \max}$	0,039 in	Maximum fillet radius

Dimensions

r_{\min}	0,039 in	Minimum chamfer dimension
D_1	1,514 in	Shoulder diameter outer ring
d_1	1,132 in	Shoulder diameter inner ring

Temperature range

T_{\min}	-22 °F	Operating temperature min.
T_{\max}	248 °F	Operating temperature max.

Calculation factors

f_0	13,1	Calculation factor
-------	------	--------------------