

**FAG****6207-N-C3**

Deep groove ball bearing

Schaeffler ID:
0167203180030Deep groove ball bearing 62...N, single
row, ring groove, steel sheet metal cage

Technical information

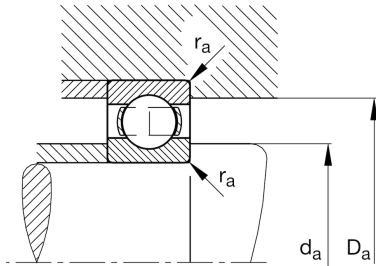
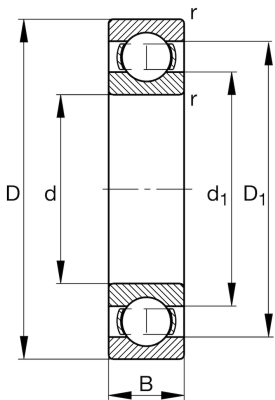

Main Dimensions & Performance Data

d	1,378 in	Bore diameter
D	2,835 in	Outside diameter
B	0,669 in	Width
C_r	6.182,554 lbf	Basic dynamic load rating, radial
C_{0r}	3.439,748 lbf	Basic static load rating, radial
C_{ur}	213,579 lbf	Fatigue load limit, radial
n_G	13.800 1/min	Limiting speed
n_{gr}	10.400 1/min	Reference speed
	9,991 oz	{Weight}

Mounting dimensions

$d_{a \min}$	1,654 in	Minimum diameter shaft shoulder
$D_{a \max}$	2,559 in	Maximum diameter of housing shoulder
$r_{a \max}$	0,039 in	Maximum fillet radius

Dimensions

r_{\min}	0,043 in	Minimum chamfer dimension
D_1	2,388 in	Shoulder diameter outer ring
d_1	1,858 in	Shoulder diameter inner ring

Temperature range

T_{\min}	-22 °F	Operating temperature min.
T_{\max}	248 °F	Operating temperature max.

Calculation factors

f_0	13,8	Calculation factor
-------	------	--------------------