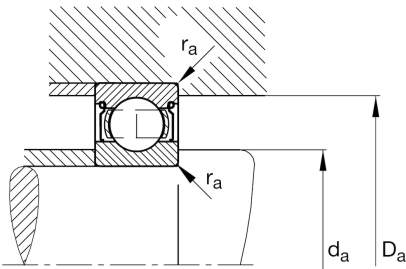
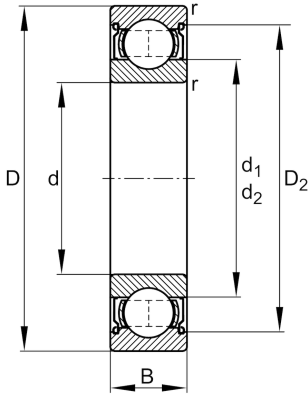

**FAG****6214-Z**

Deep groove ball bearing

Schaeffler ID:
0191049950000Deep groove ball bearing 62...-Z, single
row, shield, steel sheet metal cage

Technical information

**Main Dimensions & Performance Data**

d	2,756 in	Bore diameter
D	4,921 in	Outside diameter
B	0,945 in	Width
C_r	14.838,129 lbf	Basic dynamic load rating, radial
C_{0r}	9.892,086 lbf	Basic static load rating, radial
C_{ur}	674,46 lbf	Fatigue load limit, radial
n_G	8.200 1/min	Limiting speed
n_{gr}	6.100 1/min	Reference speed
	2,447 lbs	{Weight}

Mounting dimensions

$d_{a \min}$	3,11 in	Minimum diameter shaft shoulder
$D_{a \max}$	4,567 in	Maximum diameter of housing shoulder
$r_{a \max}$	0,059 in	Maximum fillet radius

Dimensions

r_{\min}	0,059 in	Minimum chamfer dimension
D_2	4,359 in	Caliber diameter outer ring
d_1	3,415 in	Shoulder diameter inner ring

Temperature range

T_{\min}	-22 °F	Operating temperature min.
T_{\max}	302 °F	Operating temperature max.

Calculation factors

f_0	14,4	Calculation factor
-------	------	--------------------