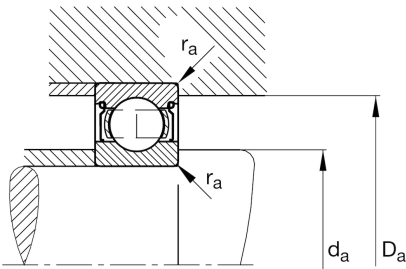
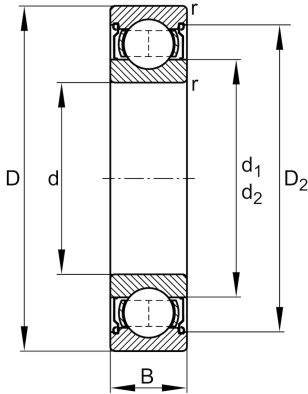

**FAG****6219-Z**

Deep groove ball bearing

Schaeffler ID:  
0167216590000Deep groove ball bearing 62...-Z, single  
row, shield , steel sheet metal cage

## Technical information

**Main Dimensions & Performance Data**

d	3,74 in	Bore diameter
D	6,693 in	Outside diameter
B	1,26 in	Width
$C_r$	26.079,137 lbf	Basic dynamic load rating, radial
$C_{0r}$	18.435,252 lbf	Basic static load rating, radial
$C_{ur}$	1.079,137 lbf	Fatigue load limit, radial
$n_G$	5.300 1/min	Limiting speed
$n_{gr}$	4.950 1/min	Reference speed
	5,71 lbs	Weight

**Mounting dimensions**

$d_{a \min}$	4,213 in	Minimum diameter shaft shoulder
$D_{a \max}$	6,22 in	Maximum diameter of housing shoulder
$r_{a \max}$	0,083 in	Maximum fillet radius

**Dimensions**

$r_{\min}$	0,083 in	Minimum chamfer dimension
$D_2$	5,939 in	Caliber diameter outer ring
$d_1$	4,657 in	Shoulder diameter inner ring

**Temperature range**

$T_{\min}$	-22 °F	Operating temperature min.
$T_{\max}$	302 °F	Operating temperature max.

**Calculation factors**

$f_0$	14,5	Calculation factor
-------	------	--------------------