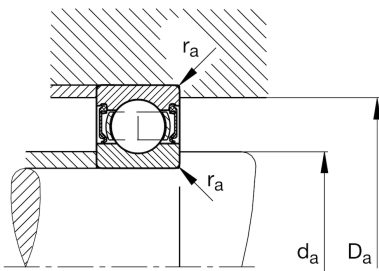
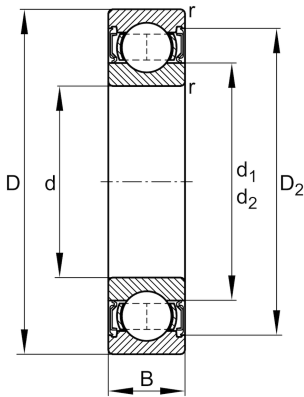

**FAG****62200-A-2RSR**

Deep groove ball bearing

Schaeffler ID:
0596140050000Deep groove ball bearing 622..-A-2RSR,
single row, steel sheet metal cage

Technical information

**Main Dimensions & Performance Data**

| | | |
|----------|---------------|-----------------------------------|
| d | 0,394 in | Bore diameter |
| D | 1,181 in | Outside diameter |
| B | 0,551 in | Width |
| C_r | 1.342,176 lbf | Basic dynamic load rating, radial |
| C_{0r} | 591,277 lbf | Basic static load rating, radial |
| C_{ur} | 44,964 lbf | Fatigue load limit, radial |
| n_G | 16.700 1/min | Limiting speed |
| | 0,097 lbs | Weight |

Mounting dimensions

| | | |
|--------------|----------|--------------------------------------|
| $d_{a \min}$ | 0,559 in | Minimum diameter shaft shoulder |
| $D_{a \max}$ | 1,016 in | Maximum diameter of housing shoulder |
| $r_{a \max}$ | 0,024 in | Maximum fillet radius |

Dimensions

| | | |
|------------|----------|------------------------------|
| r_{\min} | 0,024 in | Minimum chamfer dimension |
| D_2 | 1,014 in | Caliber diameter outer ring |
| d_1 | 0,63 in | Shoulder diameter inner ring |

Temperature range

| | | |
|------------|--------|----------------------------|
| T_{\min} | -4 °F | Operating temperature min. |
| T_{\max} | 212 °F | Operating temperature max. |

Calculation factors

| | | |
|-------|------|--------------------|
| f_0 | 12,2 | Calculation factor |
|-------|------|--------------------|