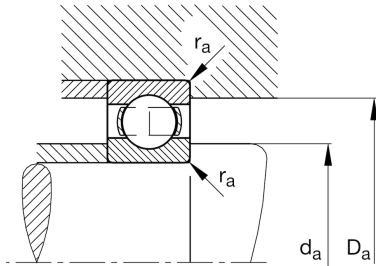
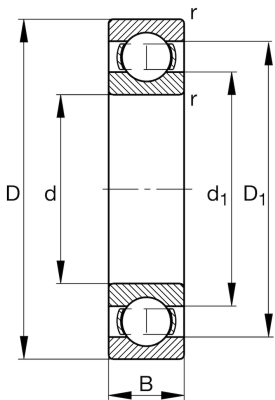

**FAG****6222-C3**

Deep groove ball bearing

Schaeffler ID:
0167218880030Deep groove ball bearing 62, single row,
steel sheet metal cage

Technical information

**Main Dimensions & Performance Data**

d	4,331 in	Bore diameter
D	7,874 in	Outside diameter
B	1,496 in	Width
C_r	34.397,482 lbf	Basic dynamic load rating, radial
C_{0r}	26.303,957 lbf	Basic static load rating, radial
C_{ur}	1.461,331 lbf	Fatigue load limit, radial
n_G	4.450 1/min	Limiting speed
n_{gr}	4.500 1/min	Reference speed
	10,229 lbs	$\{Weight\}$

Mounting dimensions

$d_{a \min}$	4,803 in	Minimum diameter shaft shoulder
$D_{a \max}$	7,402 in	Maximum diameter of housing shoulder
$r_{a \max}$	0,083 in	Maximum fillet radius

Dimensions

r_{\min}	0,083 in	Minimum chamfer dimension
D_1	6,759 in	Shoulder diameter outer ring
d_1	5,45 in	Shoulder diameter inner ring

Temperature range

T_{\min}	-22 °F	Operating temperature min.
T_{\max}	302 °F	Operating temperature max.

Calculation factors

f_0	14,3	Calculation factor
-------	------	--------------------