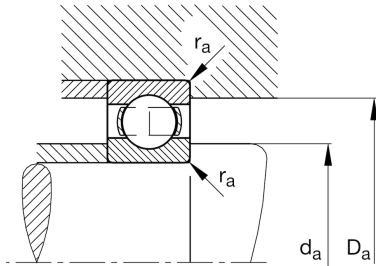
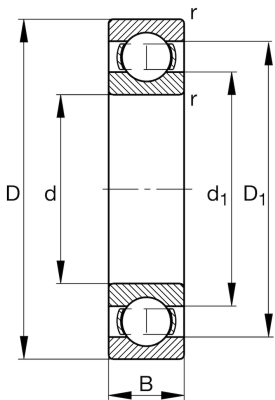

**FAG****6228-C4**

Deep groove ball bearing

Schaeffler ID:
0167219930040Deep groove ball bearing 62, single row,
steel sheet metal cage

Technical information

**Main Dimensions & Performance Data**

d	5,512 in	Bore diameter
D	9,843 in	Outside diameter
B	1,654 in	Width
C_r	42.266,187 lbf	Basic dynamic load rating, radial
C_{0r}	37.095,324 lbf	Basic static load rating, radial
C_{ur}	1.888,489 lbf	Fatigue load limit, radial
n_G	3.600 1/min	Limiting speed
n_{gr}	3.600 1/min	Reference speed
	17,791 lbs	$\{\text{Weight}\}$

Mounting dimensions

$d_{a \min}$	6,063 in	Minimum diameter shaft shoulder
$D_{a \max}$	9,291 in	Maximum diameter of housing shoulder
$r_{a \max}$	0,098 in	Maximum fillet radius

Dimensions

r_{\min}	0,118 in	Minimum chamfer dimension
D_1	8,417 in	Shoulder diameter outer ring
d_1	6,925 in	Shoulder diameter inner ring

Temperature range

T_{\min}	-22 °F	Operating temperature min.
T_{\max}	392 °F	Operating temperature max.

Calculation factors

f_0	14,9	Calculation factor
-------	------	--------------------