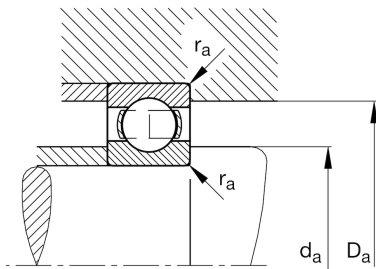
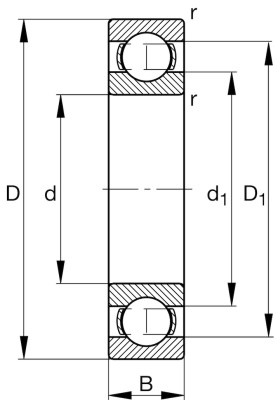

**FAG****6230-C3**

Deep groove ball bearing

Schaeffler ID:
0167220600030Deep groove ball bearing 62, single row,
steel sheet metal cage

Technical information

**Main Dimensions & Performance Data**

d	5,906 in	Bore diameter
D	10,63 in	Outside diameter
B	1,772 in	Width
C_r	42.041,367 lbf	Basic dynamic load rating, radial
C_{0r}	37.769,784 lbf	Basic static load rating, radial
C_{ur}	1.821,043 lbf	Fatigue load limit, radial
n_G	3.350 1/min	Limiting speed
n_{gr}	3.350 1/min	Reference speed
	22,708 lbs	{Weight}

Mounting dimensions

$d_{a \min}$	6,457 in	Minimum diameter shaft shoulder
$D_{a \max}$	10,079 in	Maximum diameter of housing shoulder
$r_{a \max}$	0,098 in	Maximum fillet radius

Dimensions

r_{\min}	0,118 in	Minimum chamfer dimension
D_1	9,022 in	Shoulder diameter outer ring
d_1	7,543 in	Shoulder diameter inner ring

Temperature range

T_{\min}	-22 °F	Operating temperature min.
T_{\max}	392 °F	Operating temperature max.

Calculation factors

f_0	15,2	Calculation factor
-------	------	--------------------