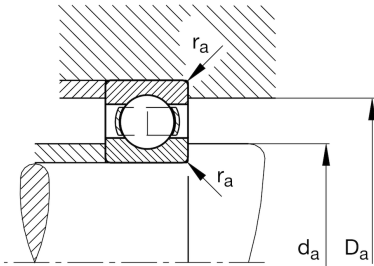
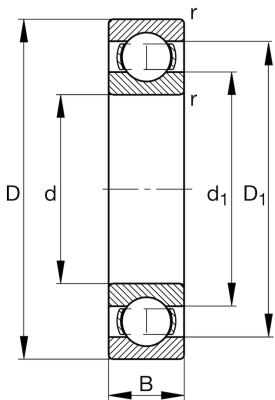

**FAG****6230-C4**

Deep groove ball bearing

Schaeffler ID:  
0167220600040Deep groove ball bearing 62, single row,  
steel sheet metal cage

## Technical information

**Main Dimensions & Performance Data**

d	5,906 in	Bore diameter
D	10,63 in	Outside diameter
B	1,772 in	Width
$C_r$	42.041,367 lbf	Basic dynamic load rating, radial
$C_{0r}$	37.769,784 lbf	Basic static load rating, radial
$C_{ur}$	1.821,043 lbf	Fatigue load limit, radial
$n_G$	3.350 1/min	Limiting speed
$n_{gr}$	3.350 1/min	Reference speed
	22,708 lbs	Weight

**Mounting dimensions**

$d_{a \min}$	6,457 in	Minimum diameter shaft shoulder
$D_{a \max}$	10,079 in	Maximum diameter of housing shoulder
$r_{a \max}$	0,098 in	Maximum fillet radius

**Dimensions**

$r_{\min}$	0,118 in	Minimum chamfer dimension
$D_1$	9,022 in	Shoulder diameter outer ring
$d_1$	7,543 in	Shoulder diameter inner ring

**Temperature range**

$T_{\min}$	-22 °F	Operating temperature min.
$T_{\max}$	392 °F	Operating temperature max.

**Calculation factors**

$f_0$	15,2	Calculation factor
-------	------	--------------------