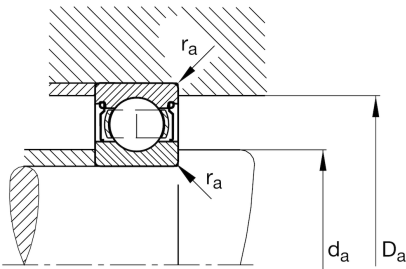
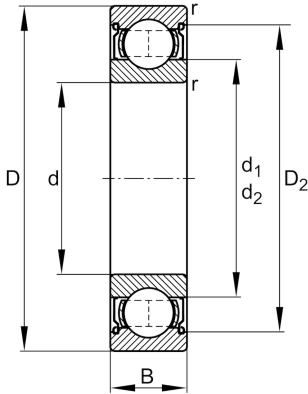

**FAG****6309-Z-C3**

Deep groove ball bearing

Schaeffler ID:  
0167235970030Deep groove ball bearing 63...-Z, single  
row, shield, steel sheet metal cage

## Technical information

**Main Dimensions & Performance Data**

d	1,772 in	Bore diameter
D	3,937 in	Outside diameter
B	0,984 in	Width
$C_r$	12.589,928 lbf	Basic dynamic load rating, radial
$C_{0r}$	7.081,835 lbf	Basic static load rating, radial
$C_{ur}$	503,597 lbf	Fatigue load limit, radial
$n_G$	9.500 1/min	Limiting speed
$n_{gr}$	8.200 1/min	Reference speed
	1,821 lbs	{Weight}

**Mounting dimensions**

$d_{a \min}$	2,126 in	Minimum diameter shaft shoulder
$D_{a \max}$	3,583 in	Maximum diameter of housing shoulder
$r_{a \max}$	0,059 in	Maximum fillet radius

**Dimensions**

$r_{\min}$	0,059 in	Minimum chamfer dimension
$D_2$	3,372 in	Caliber diameter outer ring
$d_1$	2,441 in	Shoulder diameter inner ring

**Temperature range**

$T_{\min}$	-22 °F	Operating temperature min.
$T_{\max}$	302 °F	Operating temperature max.

**Calculation factors**

$f_0$	12,9	Calculation factor
-------	------	--------------------