

**FAG****6313-C3**

Deep groove ball bearing

Schaeffler ID:  
0167239370030Deep groove ball bearing 63, single row,  
steel sheet metal cage

## Technical information

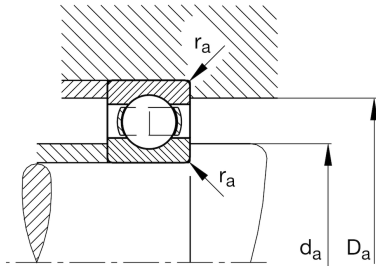
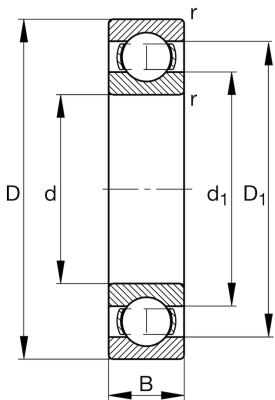

## Main Dimensions &amp; Performance Data

d	2,559 in	Bore diameter
D	5,512 in	Outside diameter
B	1,299 in	Width
$C_r$	22.482,014 lbf	Basic dynamic load rating, radial
$C_{0r}$	13.489,209 lbf	Basic static load rating, radial
$C_{ur}$	910,522 lbf	Fatigue load limit, radial
$n_G$	7.300 1/min	Limiting speed
$n_{gr}$	6.400 1/min	Reference speed
	4,614 lbs	Weight

## Mounting dimensions

$d_{a \min}$	3,031 in	Minimum diameter shaft shoulder
$D_{a \max}$	5,039 in	Maximum diameter of housing shoulder
$r_{a \max}$	0,083 in	Maximum fillet radius

## Dimensions

$r_{\min}$	0,083 in	Minimum chamfer dimension
$D_1$	4,631 in	Shoulder diameter outer ring
$d_1$	3,487 in	Shoulder diameter inner ring

## Temperature range

$T_{\min}$	-22 °F	Operating temperature min.
$T_{\max}$	302 °F	Operating temperature max.

## Calculation factors

$f_0$	13,2	Calculation factor
-------	------	--------------------