

**FAG****6319-C3**

Deep groove ball bearing

Schaeffler ID:
0167243480030Deep groove ball bearing 63, single row,
steel sheet metal cage

Technical information

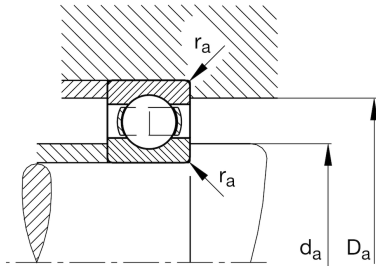
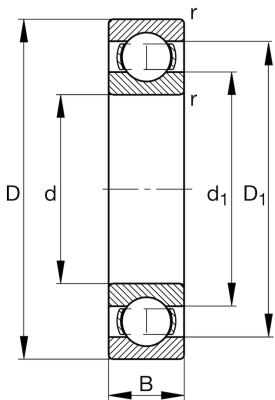

Main Dimensions & Performance Data

d	3,74 in	Bore diameter
D	7,874 in	Outside diameter
B	1,772 in	Width
C_r	34.622,302 lbf	Basic dynamic load rating, radial
C_{0r}	25.404,676 lbf	Basic static load rating, radial
C_{ur}	1.483,813 lbf	Fatigue load limit, radial
n_G	4.600 1/min	Limiting speed
n_{gr}	4.950 1/min	Reference speed
	13,314 lbs	{Weight}

Mounting dimensions

$d_{a \min}$	4,291 in	Minimum diameter shaft shoulder
$D_{a \max}$	7,323 in	Maximum diameter of housing shoulder
$r_{a \max}$	0,098 in	Maximum fillet radius

Dimensions

r_{\min}	0,118 in	Minimum chamfer dimension
D_1	6,57 in	Shoulder diameter outer ring
d_1	5,082 in	Shoulder diameter inner ring

Temperature range

T_{\min}	-22 °F	Operating temperature min.
T_{\max}	302 °F	Operating temperature max.

Calculation factors

f_0	13,8	Calculation factor
-------	------	--------------------