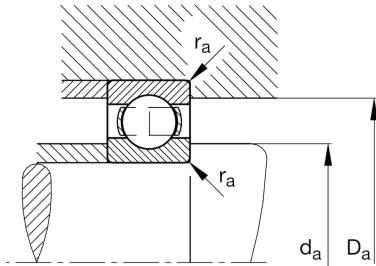
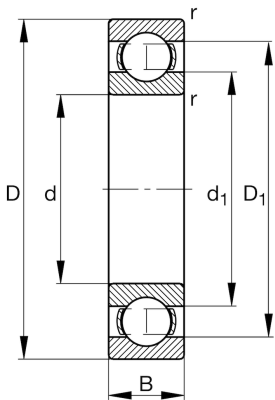

**FAG****6411-C3**

Deep groove ball bearing

Schaeffler ID:
0167247710030Deep groove ball bearing 64, single row,
steel sheet metal cage

Technical information

**Main Dimensions & Performance Data**

d	2,165 in	Bore diameter
D	5,512 in	Outside diameter
B	1,299 in	Width
C_r	22.482,014 lbf	Basic dynamic load rating, radial
C_{0r}	13.489,209 lbf	Basic static load rating, radial
C_{ur}	910,522 lbf	Fatigue load limit, radial
n_G	7.300 1/min	Limiting speed
n_{gr}	6.200 1/min	Reference speed
	5,203 lbs	Weight

Mounting dimensions

$d_{a \min}$	2,717 in	Minimum diameter shaft shoulder
$D_{a \max}$	4,961 in	Maximum diameter of housing shoulder
$r_{a \max}$	0,083 in	Maximum fillet radius

Dimensions

r_{\min}	0,083 in	Minimum chamfer dimension
D_1	4,631 in	Shoulder diameter outer ring
d_1	3,486 in	Shoulder diameter inner ring

Temperature range

T_{\min}	-22 °F	Operating temperature min.
T_{\max}	302 °F	Operating temperature max.

Calculation factors

f_0	13,2	Calculation factor
-------	------	--------------------