

FAG

7201-B-XL-JP-UA

Angular contact ball bearing

Schaeffler ID:
0191142650000

Angular contact ball bearing 72..-B-XL-JP,
single row, X-life, steel sheet metal cage



X-life

Technical information

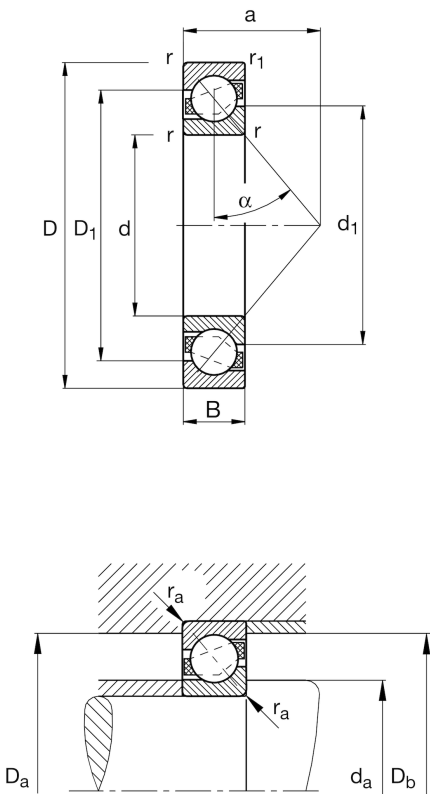

Main Dimensions & Performance Data

d	0,472 in	Bore diameter
D	1,26 in	Outside diameter
B	0,394 in	Width
C _r	1.776,079 lbf	Basic dynamic load rating, radial
C _{0r}	798,112 lbf	Basic static load rating, radial
C _{ur}	55,755 lbf	Fatigue load limit, radial
n _G	33.000 1/min	Limiting speed
n _{gr}	21.100 1/min	Reference speed
	0,093 lbs	Weight

Mounting dimensions

d _{a min}	0,638 in	Minimum diameter of shaft shoulder
D _{a max}	1,094 in	Maximum diameter of housing shoulder
D _{b max}	1,165 in	Maximum diameter of housing shoulder
r _{a max}	0,024 in	Maximum fillet radius of shaft
r _{a1 max}	0,012 in	Maximum fillet radius of housing

Dimensions

r _{min}	0,024 in	Minimum chamfer dimension
r _{1 min}	0,012 in	Minimum chamfer dimension
D ₁	0,969 in	Shoulder diameter on outer ring wide side face
d ₁	0,78 in	Shoulder diameter on inner ring wide side face
a	0,551 in	Distance between the apexes of the pressure cones
α	40 °	Contact angle

Temperature range

T _{min}	-22 °F	Operating temperature min.
T _{max}	302 °F	Operating temperature max.

The datasheet is only an overview of dimensions and basic load ratings of the selected product. Please always observe all further information and guidelines for this product. For further information you can use the contact form on our website.

Additional information

A _{min}	0,00094 in	Axial clearance per set min.
Tol (+)	0,00031 in	Tolerance for axial clearance or preload per set