

FAG

7206-B-XL-MP-UO

Angular contact ball bearing

Schaeffler ID:
0191146560000

Angular contact ball bearing 72..-B-XL-MP,
single row, X-life, solid brass cage



X-life

Technical information

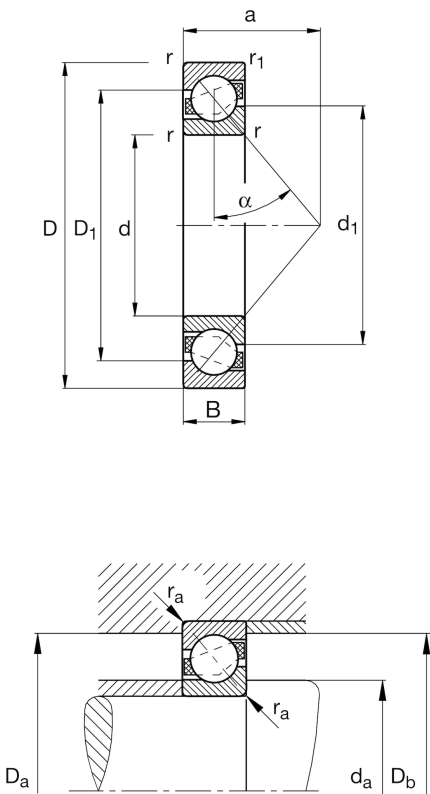

Main Dimensions & Performance Data

d	1,181 in	Bore diameter
D	2,441 in	Outside diameter
B	0,63 in	Width
C _r	4.923,561 lbf	Basic dynamic load rating, radial
C _{0r}	2.922,662 lbf	Basic static load rating, radial
C _{ur}	202,338 lbf	Fatigue load limit, radial
n _G	20.500 1/min	Limiting speed
n _{gr}	11.300 1/min	Reference speed
	0,492 lbs	Weight

Mounting dimensions

d _{a min}	1,402 in	Minimum diameter of shaft shoulder
D _{a max}	2,22 in	Maximum diameter of housing shoulder
D _{b max}	2,276 in	Maximum diameter of housing shoulder
r _{a max}	0,039 in	Maximum fillet radius of shaft
r _{a1 max}	0,024 in	Maximum fillet radius of housing

Dimensions

r _{min}	0,039 in	Minimum chamfer dimension
r _{1 min}	0,024 in	Minimum chamfer dimension
D ₁	1,949 in	Shoulder diameter on outer ring wide side face
d ₁	1,701 in	Shoulder diameter on inner ring wide side face
a	1,063 in	Distance between the apexes of the pressure cones
α	40 °	Contact angle

Temperature range

T _{min}	-22 °F	Operating temperature min.
T _{max}	302 °F	Operating temperature max.

Additional information

A _{min}	0 in	Axial clearance per set min.
Tol (+)	0,00031 in	Tolerance for axial clearance or preload per set