

FAG

7215-B-XL-JP-UA

Angular contact ball bearing

Schaeffler ID:
0191155120000

Angular contact ball bearing 72..-B-XL-JP,
single row, X-life, steel sheet metal cage



X-life

Technical information

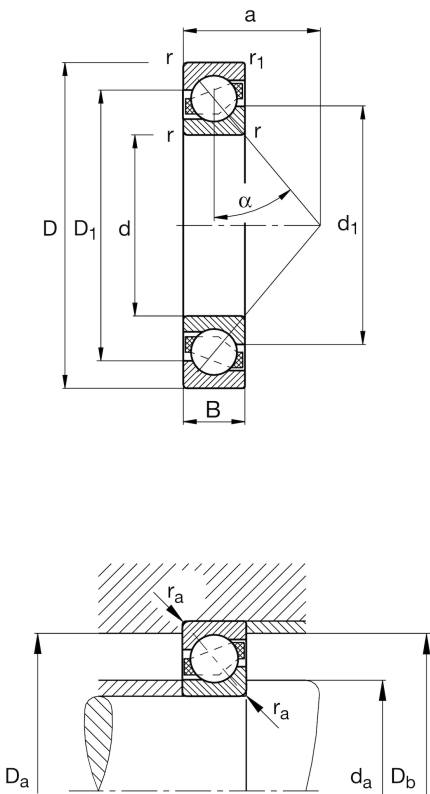

Main Dimensions & Performance Data

d	2,953 in	Bore diameter
D	5,118 in	Outside diameter
B	0,984 in	Width
C _r	16.411,871 lbf	Basic dynamic load rating, radial
C _{0r}	13.938,849 lbf	Basic static load rating, radial
C _{ur}	955,486 lbf	Fatigue load limit, radial
n _G	6.900 1/min	Limiting speed
n _{gr}	5.300 1/min	Reference speed
	2,756 lbs	Weight

Mounting dimensions

d _{a min}	3,307 in	Minimum diameter of shaft shoulder
D _{a max}	4,764 in	Maximum diameter of housing shoulder
D _{b max}	4,898 in	Maximum diameter of housing shoulder
r _{a max}	0,059 in	Maximum fillet radius of shaft
r _{a1 max}	0,039 in	Maximum fillet radius of housing

Dimensions

r _{min}	0,059 in	Minimum chamfer dimension
r _{1 min}	0,039 in	Minimum chamfer dimension
D ₁	4,299 in	Shoulder diameter on outer ring wide side face
d ₁	3,799 in	Shoulder diameter on inner ring wide side face
a	2,205 in	Distance between the apexes of the pressure cones
α	40 °	Contact angle

Temperature range

T _{min}	-22 °F	Operating temperature min.
T _{max}	302 °F	Operating temperature max.

The datasheet is only an overview of dimensions and basic load ratings of the selected product. Please always observe all further information and guidelines for this product. For further information you can use the contact form on our website.

Additional information

A _{min}	0,00197 in	Axial clearance per set min.
Tol (+)	0,00047 in	Tolerance for axial clearance or preload per set