

FAG

7220-B-XL-TVP-UO

Angular contact ball bearing

Schaeffler ID:
0191160390000

Angular contact ball bearing 72..-B-XL-TVP, single row, X-life, plastic cage

Technical information

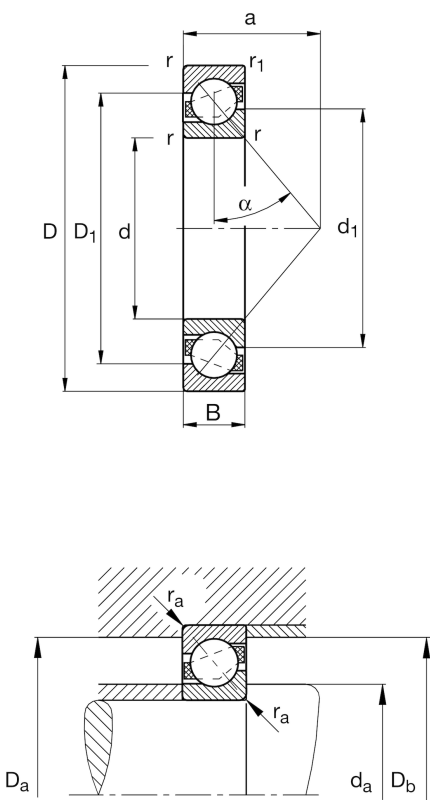

Main Dimensions & Performance Data

d	3,937 in	Bore diameter
D	7,087 in	Outside diameter
B	1,339 in	Width
C _r	31.924,46 lbf	Basic dynamic load rating, radial
C _{0r}	27.877,698 lbf	Basic static load rating, radial
C _{ur}	1.641,187 lbf	Fatigue load limit, radial
n _G	4.850 1/min	Limiting speed
n _{gr}	4.250 1/min	Reference speed
	6,923 lbs	Weight

Mounting dimensions

d _{a min}	4,409 in	Minimum diameter of shaft shoulder
D _{a max}	6,614 in	Maximum diameter of housing shoulder
D _{b max}	6,811 in	Maximum diameter of housing shoulder
r _{a max}	0,083 in	Maximum fillet radius of shaft
r _{a1 max}	0,039 in	Maximum fillet radius of housing

Dimensions

r _{min}	0,083 in	Minimum chamfer dimension
r _{1 min}	0,043 in	Minimum chamfer dimension
D ₁	5,89 in	Shoulder diameter on outer ring wide side face
d ₁	5,209 in	Shoulder diameter on inner ring wide side face
a	2,992 in	Distance between the apexes of the pressure cones
α	40 °	Contact angle

Temperature range

T _{min}	-22 °F	Operating temperature min.
T _{max}	248 °F	Operating temperature max.

Additional information

A _{min}	0 in	Axial clearance per set min.
Tol (+)	0,00047 in	Tolerance for axial clearance or preload per set