

FAG

7222-B-XL-MP

Angular contact ball bearing

Schaeffler ID:  
0191160980000

Angular contact ball bearing 72..-B-XL-MP,  
single row, X-life, solid brass cage



X-life

Technical information

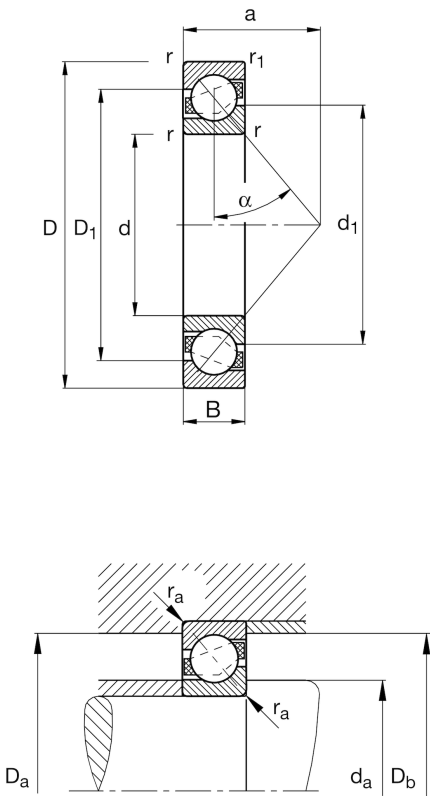

Main Dimensions & Performance Data

d	4,331 in	Bore diameter
D	7,874 in	Outside diameter
B	1,496 in	Width
C <sub>r</sub>	37.544,964 lbf	Basic dynamic load rating, radial
C <sub>0r</sub>	34.622,302 lbf	Basic static load rating, radial
C <sub>ur</sub>	1.933,453 lbf	Fatigue load limit, radial
n <sub>G</sub>	5.600 1/min	Limiting speed
n <sub>gr</sub>	3.950 1/min	Reference speed
	11,001 lbs	Weight

Mounting dimensions

d <sub>a min</sub>	4,803 in	Minimum diameter of shaft shoulder
D <sub>a max</sub>	7,402 in	Maximum diameter of housing shoulder
D <sub>b max</sub>	7,598 in	Maximum diameter of housing shoulder
r <sub>a max</sub>	0,083 in	Maximum fillet radius of shaft
r <sub>a1 max</sub>	0,039 in	Maximum fillet radius of housing

Dimensions

r <sub>min</sub>	0,083 in	Minimum chamfer dimension
r <sub>1 min</sub>	0,043 in	Minimum chamfer dimension
D <sub>1</sub>	6,524 in	Shoulder diameter on outer ring wide side face
d <sub>1</sub>	5,705 in	Shoulder diameter on inner ring wide side face
a	3,307 in	Distance between the apexes of the pressure cones
α	40 °	Contact angle

Temperature range

T <sub>min</sub>	-22 °F	Operating temperature min.
T <sub>max</sub>	302 °F	Operating temperature max.

The datasheet is only an overview of dimensions and basic load ratings of the selected product. Please always observe all further information and guidelines for this product. For further information you can use the contact form on our website.