

FAG

7321-B-XL-MP-UA

Angular contact ball bearing

Schaeffler ID:
0191183170000

Angular contact ball bearing 73..-B-XL-MP,
single row, X-life, solid brass cage



X-life

Technical information

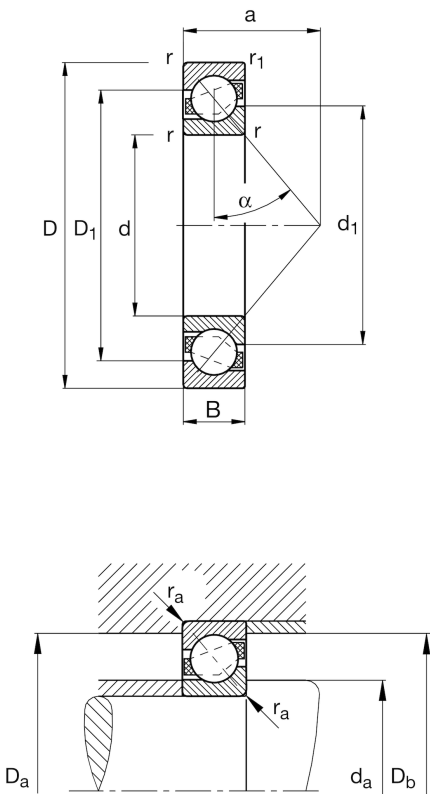

Main Dimensions & Performance Data

d	4,134 in	Bore diameter
D	8,858 in	Outside diameter
B	1,929 in	Width
C _r	50.584,532 lbf	Basic dynamic load rating, radial
C _{0r}	48.111,511 lbf	Basic static load rating, radial
C _{ur}	2.585,432 lbf	Fatigue load limit, radial
n _G	5.100 1/min	Limiting speed
n _{gr}	3.400 1/min	Reference speed
	20,499 lbs	Weight

Mounting dimensions

d _{a min}	4,685 in	Minimum diameter of shaft shoulder
D _{a max}	8,307 in	Maximum diameter of housing shoulder
D _{b max}	8,583 in	Maximum diameter of housing shoulder
r _{a max}	0,098 in	Maximum fillet radius of shaft
r _{a1 max}	0,039 in	Maximum fillet radius of housing

Dimensions

r _{min}	0,118 in	Minimum chamfer dimension
r _{1 min}	0,043 in	Minimum chamfer dimension
D ₁	7,043 in	Shoulder diameter on outer ring wide side face
d ₁	6,063 in	Shoulder diameter on inner ring wide side face
a	3,701 in	Distance between the apexes of the pressure cones
α	40 °	Contact angle

Temperature range

T _{min}	-22 °F	Operating temperature min.
T _{max}	302 °F	Operating temperature max.

The datasheet is only an overview of dimensions and basic load ratings of the selected product. Please always observe all further information and guidelines for this product. For further information you can use the contact form on our website.

Additional information

A _{min}	0,00228 in	Axial clearance per set min.
Tol (+)	0,00047 in	Tolerance for axial clearance or preload per set