

FAG

7322-B-XL-MP-UA

Angular contact ball bearing

Schaeffler ID:
0167264990000

Angular contact ball bearing 73..-B-XL-MP,
single row, X-life, solid brass cage



X-life

Technical information

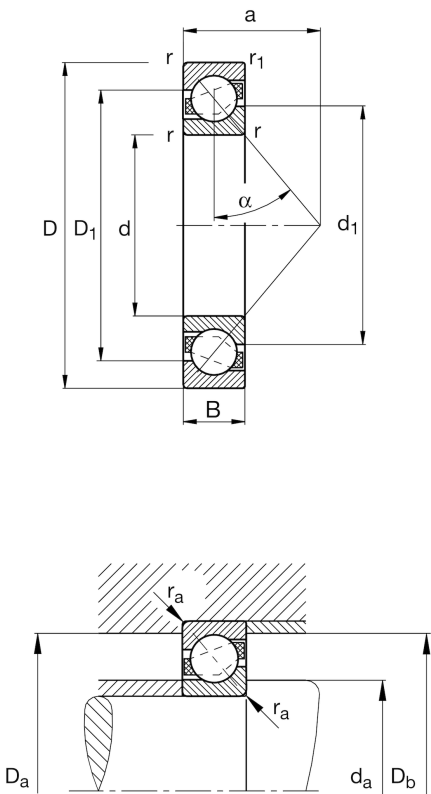

Main Dimensions & Performance Data

d	4,331 in	Bore diameter
D	9,449 in	Outside diameter
B	1,969 in	Width
C _r	56.205,036 lbf	Basic dynamic load rating, radial
C _{0r}	55.080,935 lbf	Basic static load rating, radial
C _{ur}	2.877,698 lbf	Fatigue load limit, radial
n _G	4.700 1/min	Limiting speed
n _{gr}	3.150 1/min	Reference speed
	24,251 lbs	Weight

Mounting dimensions

d _{a min}	4,882 in	Minimum diameter of shaft shoulder
D _{a max}	8,898 in	Maximum diameter of housing shoulder
D _{b max}	9,173 in	Maximum diameter of housing shoulder
r _{a max}	0,098 in	Maximum fillet radius of shaft
r _{a1 max}	0,039 in	Maximum fillet radius of housing

Dimensions

r _{min}	0,118 in	Minimum chamfer dimension
r _{1 min}	0,043 in	Minimum chamfer dimension
D ₁	7,516 in	Shoulder diameter on outer ring wide side face
d ₁	6,391 in	Shoulder diameter on inner ring wide side face
a	3,858 in	Distance between the apexes of the pressure cones
α	40 °	Contact angle

Temperature range

T _{min}	-22 °F	Operating temperature min.
T _{max}	302 °F	Operating temperature max.

The datasheet is only an overview of dimensions and basic load ratings of the selected product. Please always observe all further information and guidelines for this product. For further information you can use the contact form on our website.

Additional information

A _{min}	0,00228 in	Axial clearance per set min.
Tol (+)	0,00047 in	Tolerance for axial clearance or preload per set