

FAG

7409-B-XL-MP-UO

Angular contact ball bearing

Schaeffler ID:
0191188640000

Angular contact ball bearing 74..-B-XL-MP,
single row, X-life, solid brass cage



X-life

Technical information

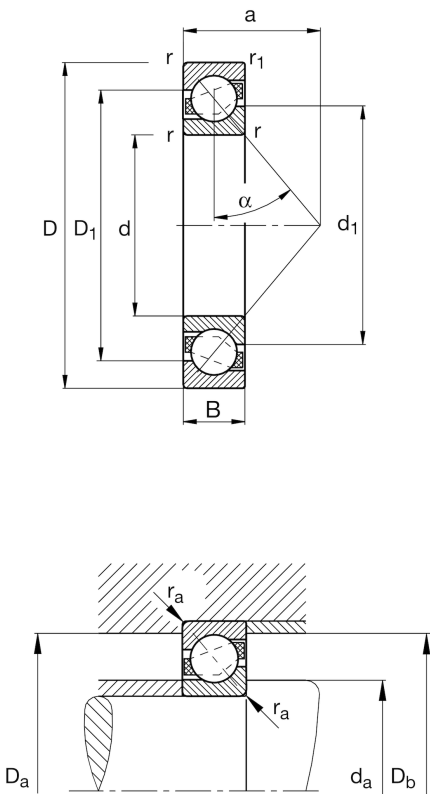

Main Dimensions & Performance Data

d	1,772 in	Bore diameter
D	4,724 in	Outside diameter
B	1,142 in	Width
C _r	19.334,532 lbf	Basic dynamic load rating, radial
C _{0r}	13.714,029 lbf	Basic static load rating, radial
C _{ur}	955,486 lbf	Fatigue load limit, radial
n _G	10.000 1/min	Limiting speed
n _{gr}	4.650 1/min	Reference speed
	3,781 lbs	Weight

Mounting dimensions

d _{a min}	2,283 in	Minimum diameter of shaft shoulder
D _{a max}	4,213 in	Maximum diameter of housing shoulder
D _{b max}	4,504 in	Maximum diameter of housing shoulder
r _{a max}	0,079 in	Maximum fillet radius of shaft
r _{a1 max}	0,039 in	Maximum fillet radius of housing

Dimensions

r _{min}	0,079 in	Minimum chamfer dimension
r _{1 min}	0,039 in	Minimum chamfer dimension
D ₁	3,752 in	Shoulder diameter on outer ring wide side face
d ₁	3,161 in	Shoulder diameter on inner ring wide side face
a	1,929 in	Distance between the apexes of the pressure cones
α	40 °	Contact angle

Temperature range

T _{min}	-22 °F	Operating temperature min.
T _{max}	302 °F	Operating temperature max.

The datasheet is only an overview of dimensions and basic load ratings of the selected product. Please always observe all further information and guidelines for this product. For further information you can use the contact form on our website.

Additional information

A _{min}	0 in	Axial clearance per set min.
Tol (+)	0,00047 in	Tolerance for axial clearance or preload per set