



FAG

B7021-E-2RSD-T-P4S-UL

Spindle bearing

Schaeffler ID:  
0388009770000

Spindle bearings B70...-E-2RSD, adjusted, in pairs or sets, contact angle  $\alpha = 25^\circ$ , lip seals on both sides, non-contact, restricted tolerances

Technical information

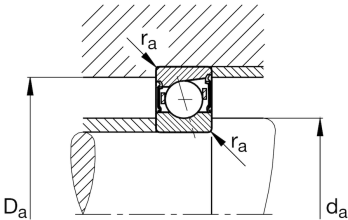
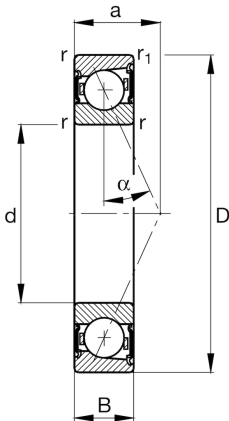

Main Dimensions & Performance Data

d	4,134 in	Bore diameter
D	6,299 in	Outside diameter
B	1,024 in	Width
C <sub>r</sub>	17.985,612 lbf	Basic dynamic load rating, radial
C <sub>0r</sub>	13.039,568 lbf	Basic static load rating, radial
C <sub>ur</sub>	1.191,547 lbf	Fatigue load limit, radial
n <sub>G Grease</sub>	7.500 1/min	Limiting speed for grease lubrication
	3,521 lbs	Weight

Mounting dimensions

d <sub>a</sub>	4,567 in	Diameter shaft shoulder
d <sub>a</sub>	h12	Diameter shaft shoulder clearance
D <sub>a</sub>	5,906 in	Shoulder diameter outer ring
D <sub>a</sub>	H12	Shoulder diameter outer ring clearance
r <sub>a max</sub>	0,079 in	Maximum recess radius
r <sub>a1 max</sub>	0,039 in	Maximum recess radius
a	1,728 in	Distance between the apexes of the pressure cones

Dimensions

r <sub>min</sub>	0,079 in	Minimum chamfer dimension
r <sub>1 min</sub>	0,079 in	Minimum chamfer dimension
α	25 °	Contact angle

Temperature range

T <sub>min</sub>	-22 °F	Operating temperature min.
T <sub>max</sub>	176 °F	Operating temperature max.

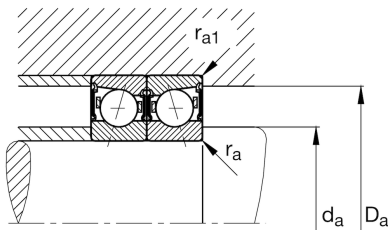

Additional information

$F_{VL}$	155,351 lbf	Preload force light
$F_{VM}$	534,397 lbf	Preload force medium
$F_{VH}$	1.114,883 lbf	Preload force heavy
$K_{aEL}$	451,888 lbf	Lift-off force light
$K_{aEM}$	1.603,642 lbf	Lift-off force medium
$K_{aEH}$	3.453,013 lbf	Lift-off force heavy
$c_{aL}$	251 N/ $\mu$ m	Axial rigidity light
$c_{aM}$	399 N/ $\mu$ m	Axial rigidity medium
$c_{aH}$	539 N/ $\mu$ m	Axial rigidity heavy