

Hub City™ CleanLine™ Gear Drives

SS HERA® Gear Drives

MODELS: SSSHERA35PS & SSSHERA45PS

COUPLED INPUT

CleanLine™ Gear Drives

K

| MODEL | C.D. | A | B | D | E | AA | BB | CC | DD | EE | GG |
|------------|-------|------|------|-------|------|-------|-------|-------|-------|----------|------|
| SSHERA35PS | 2.509 | 4.26 | 1.35 | 2.062 | 5.92 | 4.188 | 2.094 | 2.750 | 1.375 | 5/16 UNC | 0.63 |
| | | | | | | 5.000 | 2.500 | 2.875 | 1.438 | 3/8 UNC | 0.69 |
| SSHERA45PS | 3.263 | 4.90 | 1.38 | 2.500 | 7.14 | 5.000 | 2.500 | 2.875 | 1.438 | 3/8 UNC | 0.69 |

| MODEL | G | H | H2 | I | I2 | J | K | L | M | N | O | R | Wt. Lbs. |
|------------|-------|------|------|------|------|-------------|-------|-------------|-------|------|-------|-------|----------|
| SSHERA35PS | 56C | 2.25 | N/A | 7.57 | N/A | 3/16 X 3/32 | 5.875 | 4.501/4.503 | 0.625 | 6.62 | 13/32 | 0.188 | 38 |
| | 143TC | | | | | | | | 0.875 | | | | |
| SSHERA45PS | 56C | 2.26 | N/A | 7.76 | N/A | 3/16 X 3/32 | 5.875 | 4.501/4.503 | 0.625 | 6.62 | 13/32 | 0.188 | 52 |
| | 143TC | | | | | | | | 0.875 | | | | |
| | 182TC | N/A | 3.25 | N/A | 8.76 | 1/4 X 1/8 | 7.250 | 8.501/8.503 | 1.125 | 9.01 | 17/32 | 0.188 | 62 |

STOCK BORES

| MODEL | S | T | U | X | Key Furnished |
|------------|------|------|--------|-------------|---------------|
| SSHERA35PS | 6.00 | 3.00 | 3/4 | 3/16 X 3/32 | 3/16 Sq. |
| | | | 7/8 | 3/16 X 3/32 | 3/16 Sq. |
| | | | 1 | 1/4 X 1/8 | 1/4 Sq. |
| | | | 1-1/8 | 1/4 X 1/8 | 1/4 Sq. |
| | | | 1-3/16 | 1/4 X 1/8 | 1/4 Sq. |
| | | | 1-1/4 | 1/4 X 1/8 | 1/4 Sq. |
| | | | 1-7/16 | 3/8 X 1/8 | 3/8 X 5/16 |

| MODEL | S | T | U | X | Key Furnished |
|------------|------|------|--------|-----------|---------------|
| SSHERA45PS | 6.75 | 3.38 | 1 | 1/4 X 1/8 | 1/4 Sq. |
| | | | 1-1/8 | 1/4 X 1/8 | 1/4 Sq. |
| | | | 1-3/16 | 1/4 X 1/8 | 1/4 Sq. |
| | | | 1-1/4 | 1/4 X 1/8 | 1/4 Sq. |
| | | | 1-7/16 | 3/8 X 1/8 | 3/8 X 5/16 |
| | | | 1-1/2 | 3/8 X 1/8 | 3/8 X 5/16 |

BORE TOLERANCE NOMINAL + .0025

NEMA "C" FLANGE ADAPTOR KITS

| SERIES | BASE UNIT REQUIRED | | C-FLANGE KIT NO. | SHIPPING WT. LBS. | G |
|----------|--------------------|-----------|------------------|-------------------|-------|
| | MODEL | SIZE FEF. | | | |
| SSHERA35 | SSHERA35AS | 24 | 0259-00232 | 10 | 56C |
| | | | 0259-00233 | 10 | 143TC |
| SSHERA45 | SSHERA45AS | 24 | 0259-00232 | 10 | 56C |
| | | | 0259-00233 | 10 | 143TC |
| | | | 0259-00234 | 21 | 182TC |

Nema C-flange adaptor kits can be ordered separately and attached to SSSHERA_AS models. See chart for base unit requirements onto which they can be attached.

OPTIONAL MACHINED TOP

To order, specify model SSMHERA35PS OR SSMHERA45PS

| MODEL | B | E |
|-------------|-------|-------|
| SSMHERA35PS | 1.178 | 5.750 |
| SSMHERA45PS | 1.175 | 6.938 |

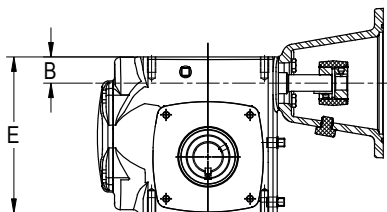

Mounting holes on the machined top are the same size and are located on the same pattern as the mounting holes on the bottom.

