



60H

Heavy Series

Superior Capacity Plus

HKK's precision power transmission roller chains are technologically advanced for high strength and low elongation. HKK Superior Capacity Plus® cold-forged solid rollers and solid bushings, is of the highest quality roller chain available. Meets or exceeds ANSI standard B29.1. The most suitable selection for most any application.

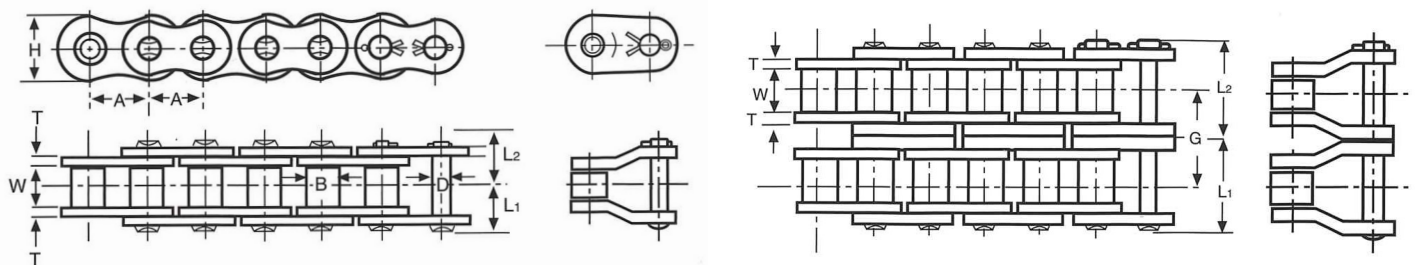

HKK ANSI #60H Specifications

HKK Chain Number	Pitch	Roller		Pin	Plate		Overall Width		Transverse	Maximum Allowable Load (Lbs)	Average Ultimate Strength (Lbs)	Average Weight Per Foot (Lbs)
		Dia.	Width	Dia.	Height	Thickness						
	A	B	W	D	H	T	L1	L2	G			
HKK 60H	3/4	.469	1/2	.234	.689	.125	.565	.644	1.028	2,000	12,300	1.21
HKK 60-2H							1.077	1.606		3,400	24,600	2.41

FEATURES

- Superior Capacity Plus®
- Cold-Forged Solid Bushings & Rollers
- Wide waist side plates
- Full strength connecting links
- Special alloy pins
- All parts shot peened
- Many other engineered advantages

Other Variations

Riveted & Cotter Type
Aqua-Series II

Made in Japan

www.HKKChain.com