

PRODUCT INFORMATION PACKET

Model No: 143TTFR16013
Catalog No: GT3203
1 1/2,3600,TEFC,143JMV,3/60/575
JM



Regal and Marathon are trademarks of Regal Beloit Corporation or one of its affiliated companies.
©2018 Regal Beloit Corporation, All Rights Reserved. MC017097E





Nameplate Specifications

Output HP	1.5 Hp	Output KW	1.12 kW
Frequency	60 Hz	Voltage	575 V
Current	1.6 A	Speed	3515 rpm
Service Factor	1.15	Phase	3
Efficiency	84 %	Duty	CONTINUOUS
Insulation Class	F	Design Code	B
KVA Code	M	Frame	143JMV
Enclosure	TEFC	Overload Protector	NOT
Ambient Temperature	40 °C	Drive End Bearing Size	6206
Opp Drive End Bearing Size	6203	UL	Recognized
CSA	Y	CE	Y
IP Code	43		

Technical Specifications

Electrical Type	SQ CAGE INV RATED	Starting Method	LINE OR INVERTER
Poles	2	Rotation	REV
Mounting	RIGID	Motor Orientation	HORIZONTAL OR SHAFT DOWN
Drive End Bearing	BALL	Opp Drive End Bearing	BALL
Frame Material	ROLLED STEEL	Shaft Type	JM
Overall Length	15.49 in	Frame Length	8.06 in
Shaft Diameter	0.88 in	Shaft Extension	4.25 in
Assembly/Box Mounting	F1 ONLY		
Outline Drawing	A-100133-806	Connection Diagram	A-EE7300

This is an uncontrolled document once printed or downloaded and is subject to change without notice. Date Created: 04/05/2018

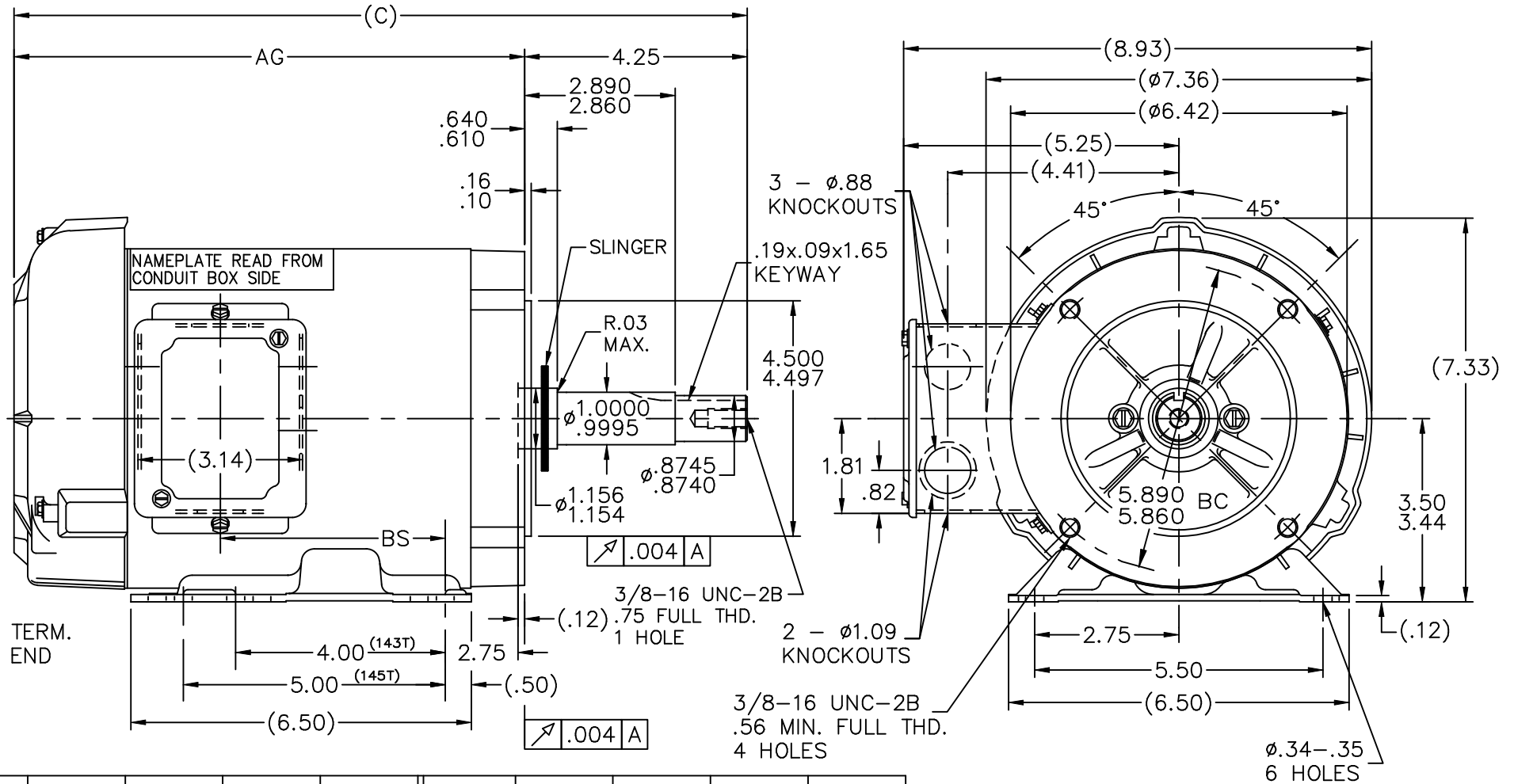

DASH	FR	C	AG	BS	DASH	FR	C	AG	BS
706	140T	14.50	10.25	3.44	856	140T	16.00	11.75	4.94
756	140T	15.00	10.75	3.94	906	140T	16.50	12.25	5.44
806	140T	15.50	11.25	4.44	956	140T	17.00	12.75	5.94

NOTE:
'C' BOX CAN BE ROTATED 180°

				TOLERANCES UNLESS SPECIFIED		MARATHON ELECTRIC	DRAWN MRB 12-20-1994							
				DEC.	INCHES		CHK	ML 12-21-1994	APPD	GK 12-21-1994				
				.X	±.1	TITLE OUTLINE JM EXT. 140 FR. - TEFC - 355C - BB - 'C' FACE	SCALE 11=32							
				.XX	±.03		REF							
				.XXX	±.005		FMF							
7	REDRAWN IN AUTOCAD	TAT 07-06-2004		ML	.XXX	±.005	PREV							
6	REDRAWN ON CADD	MRB 12-21-1994			.XXX	±.0005								
NO.	REVISION	BY & DATE		CHK	ANG	±'30"	FINISH							
THIS DRAWING IN DESIGN AND DETAIL IS OUR PROPERTY AND MUST NOT BE USED EXCEPT IN CONNECTION WITH OUR WORK ALL RIGHTS OF DESIGN AND INVENTION ARE RESERVED THIS IS AN ELECTRONICALLY GENERATED DOCUMENT - DO NOT SCALE THIS PRINT							RFP	CAD FILE	100133	SIZE	DRAWING NO.	PAGE	OF	REV.
							DIST	WP		A	100133			7

**THREE PHASE - SINGLE VOLTAGE
MOTOR - CONDUIT BOX @ 'A'**

**TO REVERSE ROTATION:
INTERCHANGE ANY TWO
LINE LEAD CONNECTIONS.**

TERMINAL BLOCK WHEN SPECIFIED

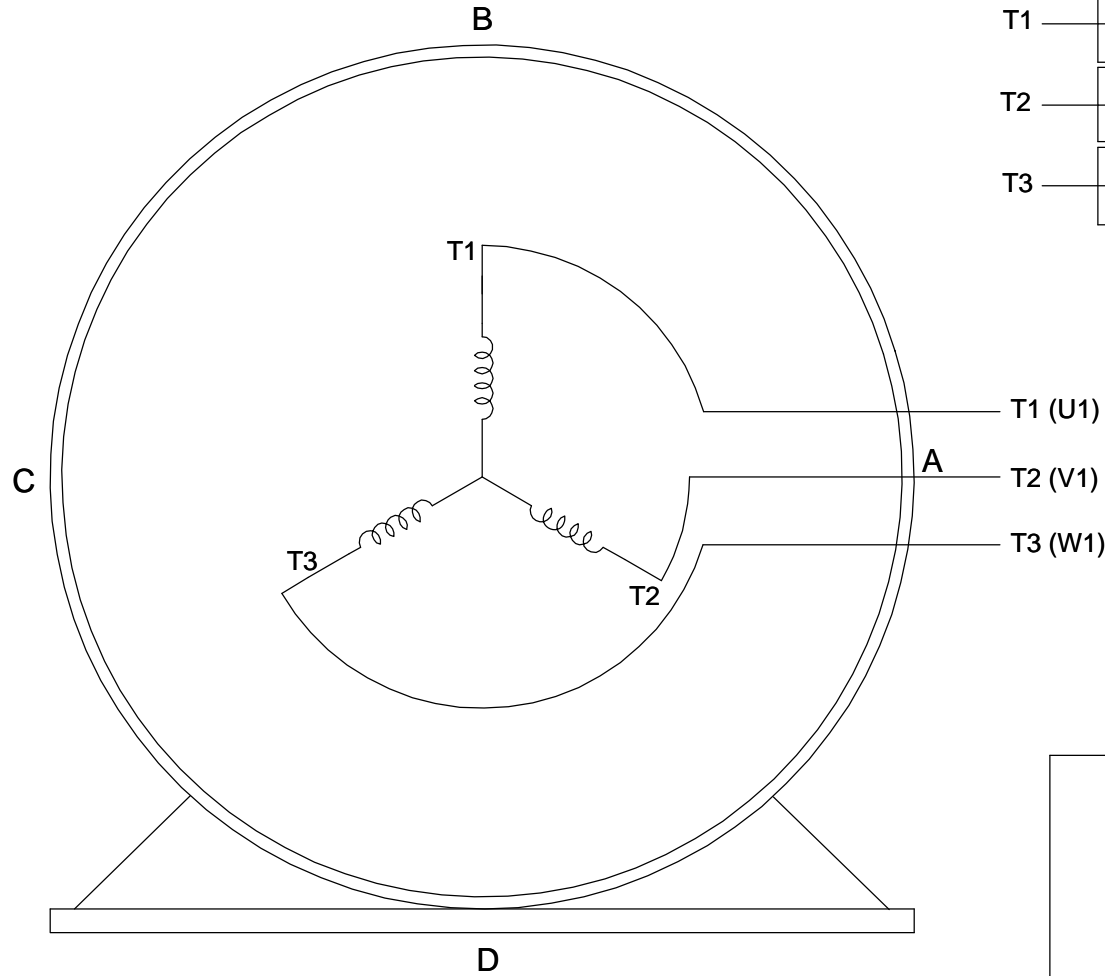
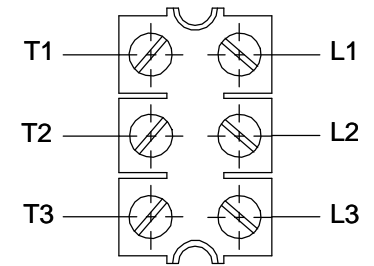

VIEW OF TERMINAL END

**IF MOTOR HAS
6 LEADS**

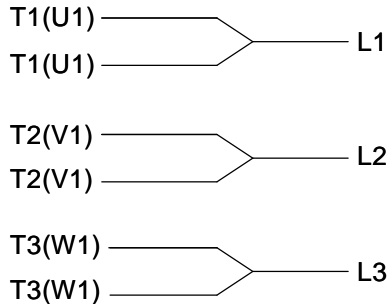

A-9806 DECAL

**OPTIONAL CORD
CONNECTION**



DRAWING REVISION AB	REVISION BY JJB	DATE 06-27-2017
ECO ECO-0125361	APPROVED BY TB	DATE 06-27-2017
ECO DESCRIPTION UPDATED TO CURRENT STANDARDS		
<small>COPYRIGHT REGAL BELOIT AMERICA, INC. ALL RIGHTS RESERVED. PROPRIETARY AND CONFIDENTIAL INFORMATION - THIS DOCUMENT IS THE PROPERTY OF REGAL BELOIT AMERICA, INC. ("OWNER") AND CONTAINS OWNER'S PROPRIETARY INFORMATION. ANY PERSON, CORPORATION OR OTHER FIRM RECEIVING IT IS DEEMED, BY RECEIVING IT, TO AGREE THAT IT, AND/OR ANY PART OF IT, SHALL NOT BE DISCLOSED TO ANY PERSON, CORPORATION OR OTHER ENTITY, DUPLICATED, AND/OR USED, EXCEPT AS EXPRESSLY APPROVED IN WRITING IN ADVANCE BY OWNER. THIS DOCUMENT SHALL BE RETURNED TO OWNER UPON REQUEST. IT MAY BE SUBJECT TO CERTAIN RESTRICTIONS UNDER APPLICABLE EXPORT CONTROL LAWS AND REGULATIONS.</small>		

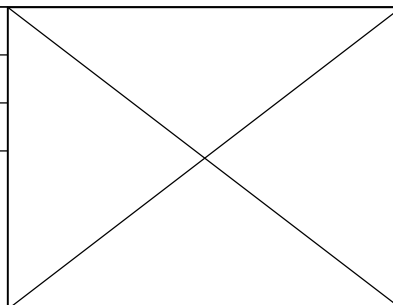

DRAWN BY DA
DATE 03-26-1993
APPROVED BY TB
DATE 03-26-1993
REFERENCE
THIRD ANGLE PROJECTION

Regal Beloit America, Inc.		
		DESCRIPTION CONNECTION DIAGRAM EXTERNAL - SINGLE VOLTAGE - 3Ø MOTOR
MATERIAL	PROCESS/FINISH	
SIZE A	DRAWING NUMBER EE7300	SHEET 1 OF 1

CERTIFICATION DATA SHEET

Model#: 143TTFR16013 AA WINDING#: ZT2141 R1 2
CONN. DIAGRAM: A-EE7300 ASSEMBLY: F1 ONLY
OUTLINE: A-100133-806

TYPICAL MOTOR PERFORMANCE DATA

Table with 8 columns: HP, KW, SYNC. RPM, F.L. RPM, FRAME, ENCLOSURE, KVA CODE, DESIGN. Row 1: 1 1/2, 1.12, 3600, 3515, 143JMV, TEFC, M, B

Table with 10 columns: PH, Hz, VOLTS, FL AMPS, START TYPE, DUTY, INSL, S.F, AMB°C, ELEVATION. Row 1: 3, 60, 575, 1.6, LINE OR INVERTER, CONTINUOUS, F3, 1.15, 40, 3300

Table with 6 columns: FULL LOAD EFF: 84, 3/4 LOAD EFF: 84.8, 1/2 LOAD EFF: 82.3, GTD. EFF, ELEC. TYPE, NO LOAD AMPS. Row 1: 83.5, 77.8, 67.2, 82.5, SQ CAGE INV RATED, .7

Table with 5 columns: F.L. TORQUE, LOCKED ROTOR AMPS, L.R. TORQUE, B.D. TORQUE, F.L. RISE°C. Row 1: 2.2 LB-FT, 15.5, 7.3 LB-FT 332, 9.6 LB-FT 435, 38

Table with 6 columns: SOUND PRESSURE @ 3 FT., SOUND POWER, ROTOR WK^2, MAX. WK^2, SAFE STALL TIME, STARTS /HOUR, APPROX. MOTOR WGT. Row 1: 69 dBA, 79 dBA, 0.045 LB-FT^2, 3 LB-FT^2, 20 SEC., 2, 55 LBS.

*** SUPPLEMENTAL INFORMATION ***

Table with 9 columns: DE BRACKET TYPE, ODE BRACKET TYPE, MOUNT TYPE, ORIENTATION, SEVERE DUTY, HAZARDOUS LOCATION, DRIP COVER, SCREENS, PAINT. Row 1: C-FACE, STANDARD, RIGID, HORIZONTAL OR SHAFT DOWN, FALSE, NONE, PROVISIONS ONLY, NONE, BLUE (POWDER)

Table with 8 columns: BEARINGS (DE, OPE), GREASE, SHAFT TYPE, SPECIAL DE, SPECIAL ODE, SHAFT MATERIAL, FRAME MATERIAL. Row 1: BALL, BALL, POLYREX EM, JM, NONE, NONE, 1144 STRESSPROOF (C-223), ROLLED STEEL

Table with 7 columns: THERMO-PROTECTORS (THERMOSTATS, PROTECTORS, WDG RTDs, BRG RTDs), THERMISTORS, CONTROL, SPACE /n HEATERS. Row 1: NONE, NOT, NONE, NONE, NONE, FALSE, NONE VOLTS

If Inverter equals NONE, contact factory for further information

* N O T E S *

Table with 2 columns: INVERTER TORQUE: CONSTANT 2:1, INV. HP SPEED RANGE: NONE, ENCODER: NONE, NONE NONE, NONE NONE PPR, BRAKE: NONE NONE, NONE P/N NONE, NONE NONE, - FT-LB NONE V NONE Hz

DATE: 06/22/2017 11:57:55 PM
FORM 3531 REV.3 02/07/99
** Subject to change without notice.

Data Sheet

143TFR16013



Submission
Data @ 575 V

Date: 6/19/2017
Customer: _____
Attention: _____
Submitted by: FAREEDA DUDEKULA

Load	Motor Load Data							
	0%	25%	50%	75%	100%	115%	125%	LR
Current (Amps)	0.72	0.80	1.04	1.28	1.60	1.76	1.92	15.5
Torque (ft-lb)	0.00	0.60	1.10	1.70	2.20	2.60	2.80	7.3
RPM	3600	3575	3555	3535	3515	3500	3485	0
Efficiency (%)		73.4	82.3	84.8	84.0	84.0	84.0	
P.F. (%)	17.0	47.5	67.2	77.8	83.5	85.1	86.8	58.0

Motor Speed Data

	LR	Pull-Up	BD	Rated	Idle
Speed (rpm)	0	650	2815	3515	3600
Current (Amps)	15.5	14.9	9.7	1.60	0.72
Torque (ft-lb)	7.3	6.1	9.6	2.20	0.00

Information Block

HP	1.5
Sync. RPM	3600
Frame	143
Enclosure	TEFC
Construction	TFR
Voltage	575 V
Frequency	60 HZ
Design	A
LR Code letter	M
Service Factor	1.15
Temp Rise @ FL	38 °C
Duty	CONT
Ambient	40 °C
Elevation	1,000 feet
Rotor/Shaft wkt	0.05 Lb-Fe
Rel Wdg	ZT2141 R1
Sound Pressure @ 1M	69 dBA
VFD Rating	CONSTANT 2:1
Outline Dwg	A-100133-806
Conn. Diag	A-EEZ300
Additional Specifications:	
0	

EQUIV CKT (OHMS / PHASE)				
R1	R2	X1	X2	Xm
2.2170	1.4780	3.6210	3.3260	124.9020

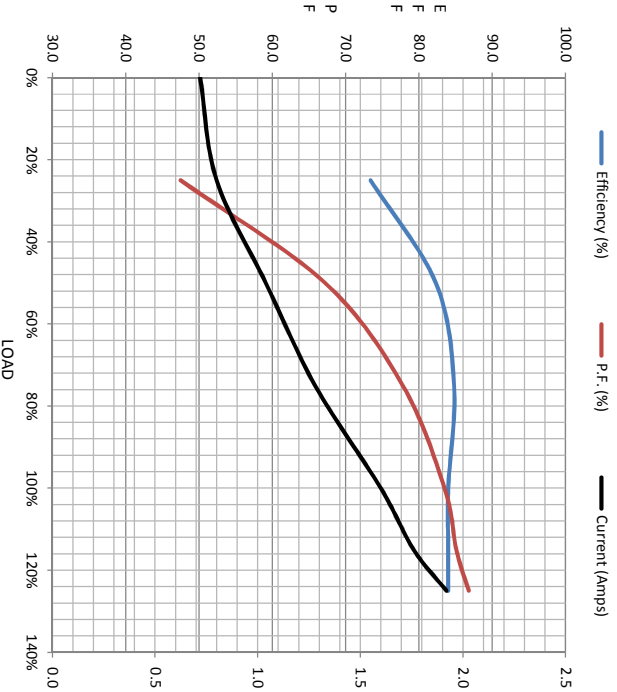

Speed - Torque Curve

