

# DUTY MASTER ALTERNATING CURRENT MOTORS

## SQUIRREL-CAGE INDUCTION

ENCLOSURE: TOTALLY ENCLOSED

COOLING: FAN COOLED

MOUNTING: FOOT, F1

## G445TS/G444TS FRAME MOUNTING HOLES

ENCLOSURE ENHANCEMENT: 841-XL

CONDUIT BOX WITH 4" NPT

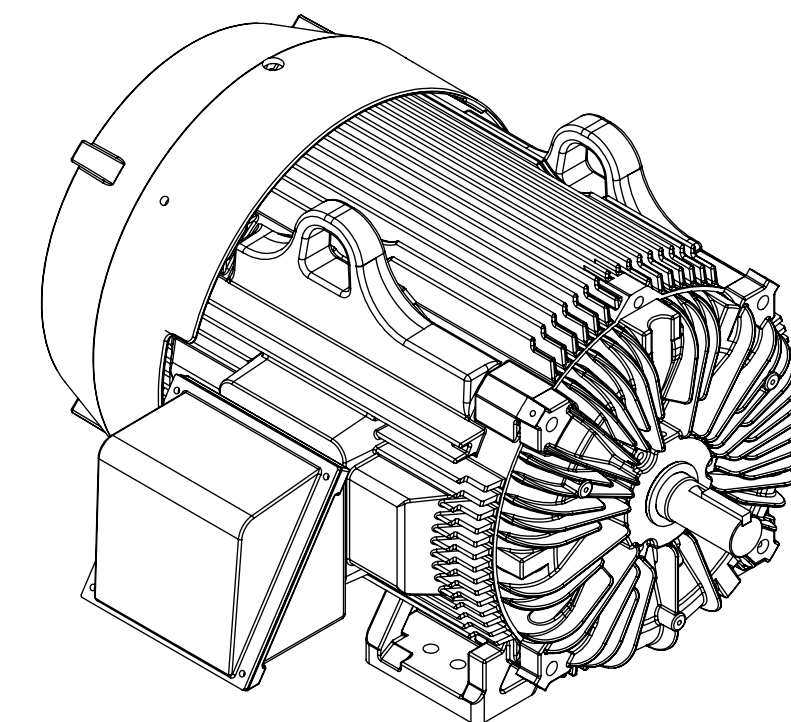
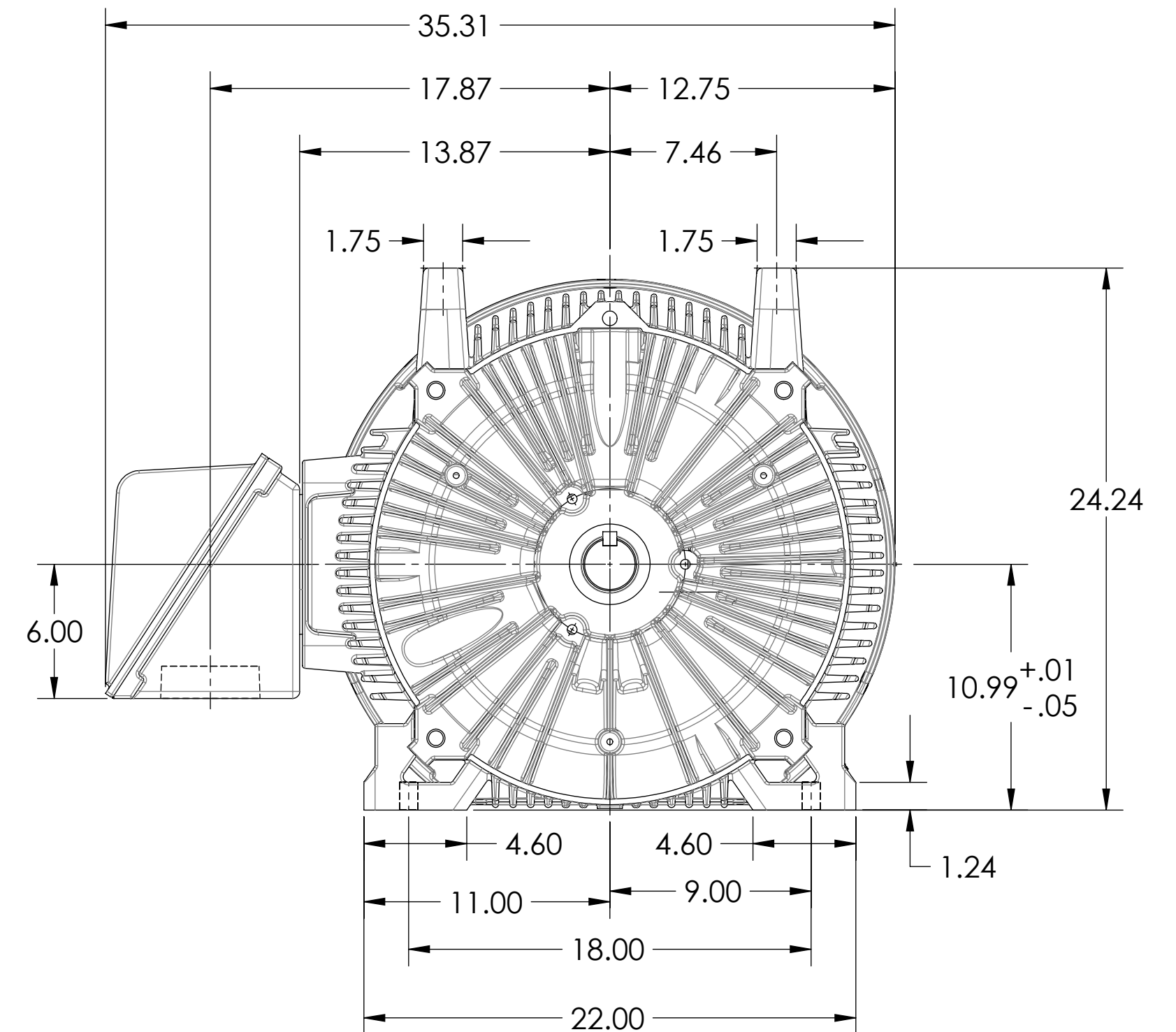
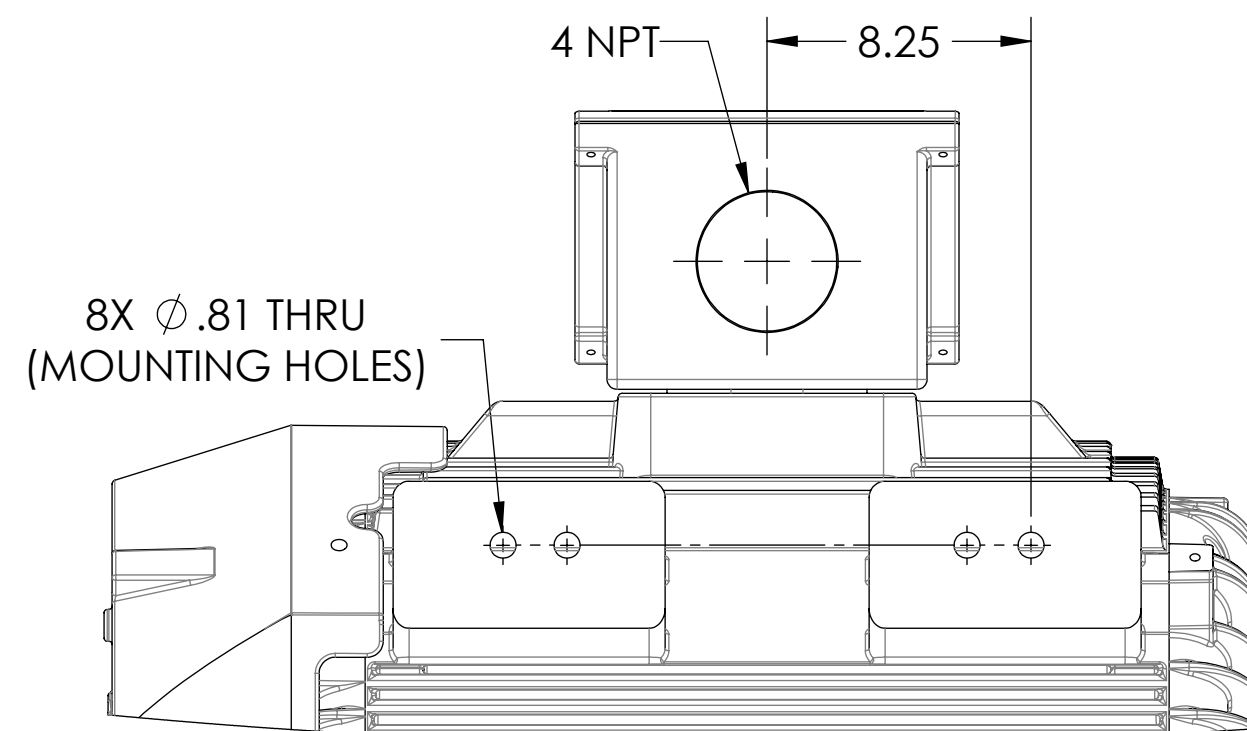
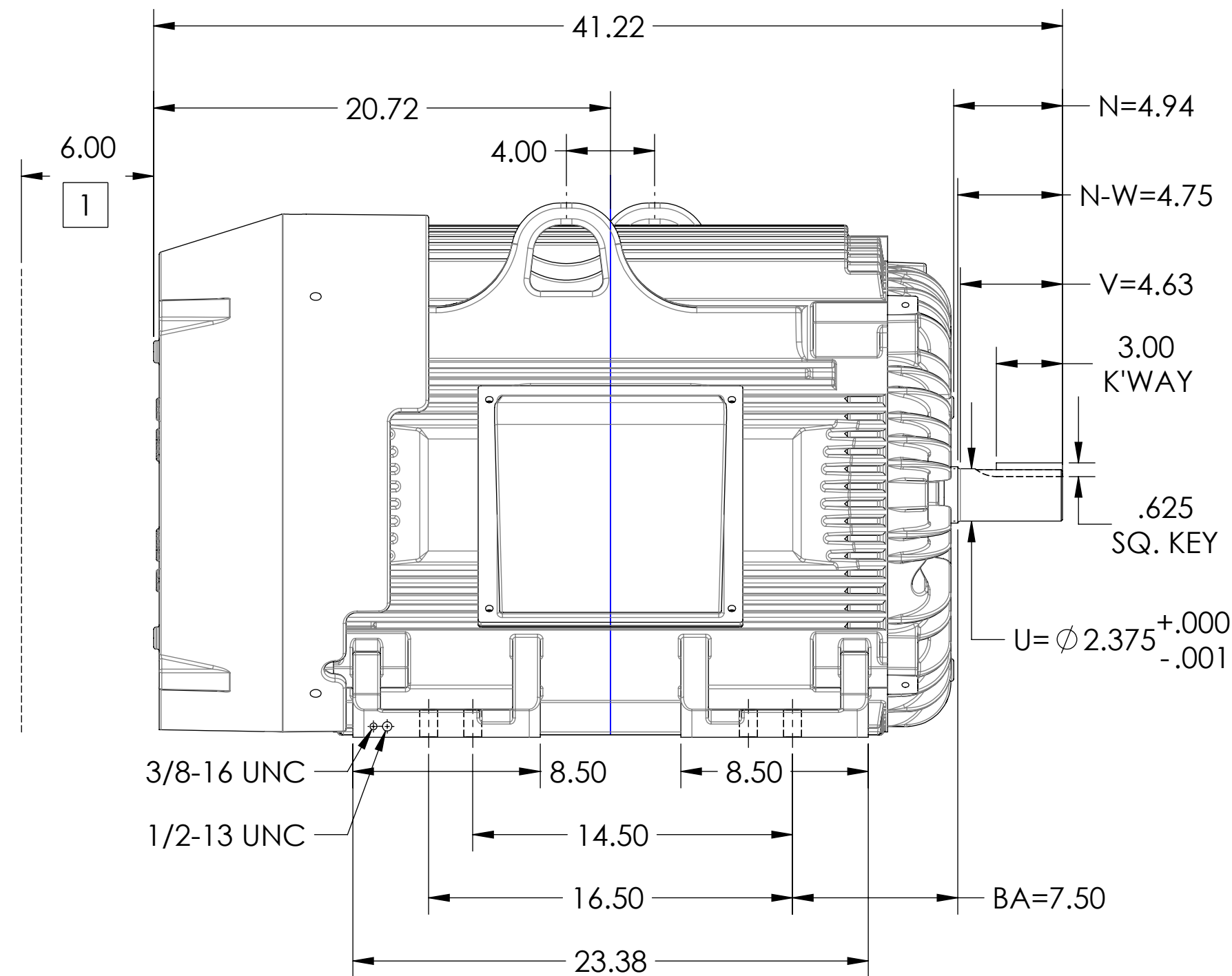

1. OBSTRUCTION MUST NOT ENCROACH ON AIR INLET

IF MOUNTING CLEARANCE DETAILS ARE REQUIRED, CONSULT FACTORY.  
MAXIMUM PERMISSIBLE SHAFT RUNOUT WHEN MEASURED AT END OF  
STANDARD SHAFT EXTENSION IS .0015" T.I.R. TO 5 INCH DIA.

DIMENSIONS ARE IN INCHES.  
WEIGHT (LBS): 2100, MOTOR WEIGHTS MAY VARY BY 15% DEPENDING ON RATING.  
CUSTOMER IS RESPONSIBLE FOR DETERMINING THAT MOTOR PERFORMANCE IS SUITABLE IN THE APPLICATION.

REV. DESC: UPDATED BA DIMENSION 7.50			
REV: A	VERSION: 01	REVISED: 01:31:26 06/22/2016	TDR: 000000985685
MODEL NO. 617427-213			REF:
BY: USJEDIL		Material:	

# BALDOR

G445TS/444TS STD – FOOTED – SIDE/CENTER C/B - 841XL