

SPROCKETS FOR No. 50. 5/8" PITCH ANSI CHAIN
TABLE No. 1 STEEL SINGLE SPROCKETS WITH Q-D® BUSHINGS

PART No.	BUSHING	BORE RANGE	DIAMETERS		TYPE	No. TEETH	DIMENSIONS					Wt. LESS BUSHING
			OUTSIDE	PITCH			T NOM.	OL	L	P	H	
H50JA12*	JA	1/2 - 1 1/4"	2.71"	2.415"	QD-1	12	.343"	1 5/16"	.89"	53/64"	2"	.35
H50JA13*	JA	1/2 - 1 1/4"	2.91	2.612	QD-1	13	.343	1 5/16	.89	53/64	2	.44
H50JA14	JA	1/2 - 1 1/4"	3.11	2.803	QD-1	14	.343	1 5/16	.89	53/64	2	.60
H50JA15	JA	1/2 - 1 1/4"	3.32	3.006	QD-1	15	.343	1 5/16	.89	53/64	2	.69
H50JA16	JA	1/2 - 1 1/4"	3.52	3.204	QD-1	16	.343	1 5/16	.89	53/64	2	.79
H50SH17	SH	1/2 - 1 5/8"	3.72	3.401	QD-1	17	.343	1 11/16	1.2	1 11/64	2 11/16	1.09
H50SH18	SH	1/2 - 1 5/8"	3.92	3.599	QD-1	18	.343	1 11/16	1.2	1 11/64	2 11/16	1.26
H50SH19	SH	1/2 - 1 5/8"	4.12	3.797	QD-1	19	.343	1 11/16	1.2	1 11/64	2 11/16	1.40
H50SDS20	SDS	1/2 - 2"	4.32	3.995	QD-1	20	.343	1 21/32	1 9/16	1 9/64	3 1/8	1.37
H50SDS21	SDS	1/2 - 2"	4.52	4.194	QD-1	21	.343	1 21/32	1 9/16	1 9/64	3 1/8	1.49
H50SDS22	SDS	1/2 - 2"	4.72	4.392	QD-1	22	.343	1 21/32	1 9/16	1 9/64	3 1/8	1.62
H50SDS23	SDS	1/2 - 2"	4.92	4.590	QD-1	23	.343	1 21/32	1 9/16	1 9/64	3 1/8	1.75
H50SDS24	SDS	1/2 - 2"	5.12	4.788	QD-1	24	.343	1 21/32	1 9/16	1 9/64	3 1/8	1.88
H50SDS25	SDS	1/2 - 2"	5.32	4.987	QD-1	25	.343	1 21/32	1 9/16	1 9/64	3 1/8	2.01
H50SDS26	SDS	1/2 - 2"	5.52	5.185	QD-1	26	.343	1 21/32	1 9/16	1 9/64	3 1/8	2.15
H50SDS27	SDS	1/2 - 2"	5.72	5.384	QD-1	27	.343	1 21/32	1 9/16	1 9/64	3 1/8	2.30
H50SDS28	SDS	1/2 - 2"	5.92	5.582	QD-1	28	.343	1 21/32	1 9/16	1 9/64	3 1/8	2.45
H50SDS30	SDS	1/2 - 2"	6.32	5.979	QD-1	30	.343	1 21/32	1 9/16	1 9/64	3 1/8	2.77
H50SDS32	SDS	1/2 - 2"	6.72	6.376	QD-1	32	.343	1 21/32	1 9/16	1 9/64	3 1/8	3.11
H50SDS35	SDS	1/2 - 2"	7.32	6.972	QD-1	35	.343	1 21/32	1 9/16	1 9/64	3 1/8	3.66
H50SDS36	SDS	1/2 - 2"	7.52	7.171	QD-1	36	.343	1 21/32	1 9/16	1 9/64	3 1/8	3.86
H50SDS40	SDS	1/2 - 2"	8.32	7.966	QD-1	40	.343	1 21/32	1 9/16	1 9/64	3 1/8	4.70
50SDS42	SDS	1/2 - 2"	8.72	8.363	QD-1	42	.343	1 21/32	1 9/16	1 9/64	3 1/8	5.15
50SDS45	SDS	1/2 - 2"	9.31	8.960	QD-1	45	.343	1 21/32	1 9/16	1 9/64	3 1/8	5.86
50SDS48	SDS	1/2 - 2"	9.91	9.556	QD-1	48	.343	1 21/32	1 9/16	1 9/64	3 1/8	6.63
50SK54	SK	1/2 - 2 5/8"	11.11	10.749	QD-1	54	.343	2 23/64	1 3/4	1 13/16	3 7/8	9.24
50SK60	SK	1/2 - 2 5/8"	12.30	11.942	QD-1	60	.343	2 23/64	1 3/4	1 13/16	3 7/8	11.1
50SK70	SK	1/2 - 2 5/8"	14.29	13.931	QD-1	70	.343	2 23/64	1 3/4	1 13/16	3 7/8	14.7
50SK72	SK	1/2 - 2 5/8"	14.69	14.329	QD-1	72	.343	2 23/64	1 3/4	1 13/16	3 7/8	15.5
50SF80	SF	1/2 - 2 15/16"	16.28	15.920	QD-1	80	.343	2 25/64	2	1 13/16	4 5/8	19.4
50SF84	SF	1/2 - 2 15/16"	17.08	16.715	QD-1	84	.343	2 25/64	2	1 13/16	4 5/8	21.2
50SF96	SF	1/2 - 2 15/16"	19.47	19.102	QD-1	96	.343	2 25/64	2	1 13/16	4 5/8	27.2
50SF112	SF	1/2 - 2 15/16"	22.65	22.285	QD-1	112	.343	2 25/64	2	1 13/16	4 5/8	36.4

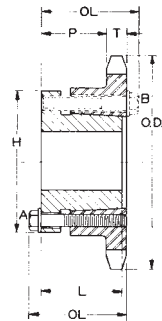

Type QD-1

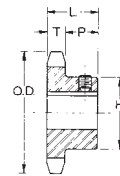

Type 1

* Bushings mounts with capscrews on "A" side only

TABLE No. 2 STEEL SINGLE SPROCKETS WITH BROWNING SPLIT TAPER® BUSHINGS

PART No.	DIAMETERS		No. TEETH	TYPE	STOCK BORES MARKED "X"													DIMENSIONS			Wt. Lbs.
	OUTSIDE	PITCH			5/8"	3/4"	7/8"	1"	1 1/8"	1 1/16"	1 1/4"	1 3/8"	1 7/16"	1 1/2"	1 5/8"	1 11/16"	1 3/4"	1 15/16"	T NOM.	L	
STOCK STEEL SPROCKETS																					
H509	2.09"	1.827"	9	1	x	x	-	-	-	-	-	-	-	-	-	-	-	.343"	1"	21/32"	.3
H5010	2.30	2.023	10	1	x	x	x	x*	-	-	-	-	-	-	-	-	-	.343	1	21/32	.5
H5011	2.50	2.219	11	1	x	x	x	x	-	-	-	-	-	-	-	-	-	.343	1	21/32	.6
H5012	2.70	2.415	12	1	x	x	x	x	x	x	-	-	-	-	-	-	-	.343	1	21/32	.7
H5013	2.91	2.612	13	1	x	x	x	x	x	x	-	-	-	-	-	-	-	.343	1	21/32	.8
H5014	3.11	2.809	14	1	x	x	x	x	x	x	x	-	-	-	-	-	-	.343	1	21/32	1.0
H5015	3.32	3.006	15	1	x	x	x	x	x	x	x	x	-	-	-	-	-	.343	1	21/32	1.3
H5016	3.52	3.204	16	1	x	x	x	x	x	x	x	x	x	-	-	-	-	.343	1	21/32	1.5
H5017	3.72	3.401	17	1	x	x	x	x	x	x	x	x	x	x	-	-	-	.343	1	21/32	1.6
H5018	3.92	3.599	18	1	x	x	x	x	x	x	x	x	x	x	-	-	-	.343	1	21/32	1.8
H5019	4.12	3.797	19	1	x	x	x	x	x	x	x	x	x	x	-	-	-	.343	1	21/32	1.9
H5020	4.32	3.995	20	1	-	x	x	x	x	x	x	x	x	x	-	-	-	.343	1	21/32	2.5
H5021	4.52	4.194	21	1	-	x	x	x	x	x	x	x	x	x	-	-	-	.343	1	21/32	2.6
H5022	4.72	4.392	22	1	-	x	x	x	x	x	x	x	x	x	-	-	-	.343	1	21/32	2.7
H5023	4.92	4.590	23	1	-	x	x	x	x	x	x	x	x	x	-	-	-	.343	1	21/32	3.3
H5024	5.12	4.788	24	1	-	x	x	x	x	x	x	x	x	x	-	-	-	.343	1 1/4	29/32	3.0
H5025	5.32	4.987	25	1	-	x	x	x	x	x	x	x	x	x	-	-	-	.343	1 1/4	29/32	3.6
H5026	5.52	5.185	26	1	-	x	x	x	x	x	x	x	x	x	-	-	-	.343	1 1/4	29/32	3.8
H5027	5.72	5.384	27	1	-	x	x	x	x	x	x	x	x	x	-	-	-	.343	1 1/4	29/32	3.9
H5028	5.92	5.582	28	1	-	x	x	x	x	x	x	x	x	x	-	-	-	.343	1 1/4	29/32	4.1
H5029	6.12	5.781	29	1	-	x	x	x	x	x	x	x	x	x	-	-	-	.343	1 1/4	29/32	4.3
H5030	6.32	5.979	30	1	-	x	x	x	x	x	x	x	x	x	-	-	-	.343	1 1/4	29/32	4.4
H5032	6.72	6.376	32	1	-	x	-	x	x	x	x	x	x	x	-	-	-	.343	1 1/4	29/32	4.7
H5033	6.92	6.575	33	1	-	-	-	-	x	-	-	-	-	-	-	-	-	.343	1 1/4	29/32	4.9
H5034	7.12	6.774	34	1	-	-	-	-	-	-	-	-	-	x	-	-	-	.343	1 1/4	29/32	5.1
H5035	7.32	6.972	35	1	-	x	-	x	-	x	-	x	x	-	-	-	-	.343	1 1/4	29/32	5.4
H5036	7.52	7.171	36	1	-	x	-	x	-	x	-	x	x	-	-	-	-	.343	1 1/4	29/32	5.6
H5038	7.92	7.569	38	1	-	-	-	-	-	-	-	-	-	-	-	-	-	.343	1 1/4	29/32	5.9
H5039	8.12	7.767	39	1	-	-	-	-	-	-	-	-	-	-	-	-	-	.343	1 1/4	29/32	6.0
H5040	8.32	7.966	40	1	-	-	-	x	x	-	x	-	x	-	-	-	-	.343	1 1/4	29/32	6.2
5041	8.52	8.165	41	1	-	-	-	-	-	-	-	-	-	-	-	-	x	.343	1 1/4	29/32	6.3
5042	8.72	8.363	42	1	-	-	-	-	x	-	-	-	-	-	-	-	-	.343	1 1/4	29/32	6.5
5045	9.31	8.960	45	1	-	-	-	-	-	x	-	-	x	-	-	-	x	.343	1 1/4	29/32	6.9
5048	9.91	9.556	48	1	-	-	-	-	-	-	-	-	-	x	-	-	-	.343	1 1/4	29/32	7.2
5049	10.11	9.755	49	1	-	-	-	-	-	-	-	-	-	-	-	-	-	.343	1 1/4	29/32	7.5
5050	10.31	9.954	50	1	-	-	-	-	-	-	-	-	-	-	-	-	-	.343	1 1/4	29/32	7.8
5060	12.30	11.942	60	1	-	-	-	-	-	-	-	-	-	-	-	-	x	.343	1 1/4	29/32	10.8

Except where noted, all Stock Finished Bore Sprockets are furnished with Standard Keyway on Centerline of Tooth and Hollow Head Setscrews over the Keyway and at 90° to Keyway.

* These bore sizes have setscrews at 90° and 180° from the Keyway.