

Flange Mounted - Double/Triple Reduction

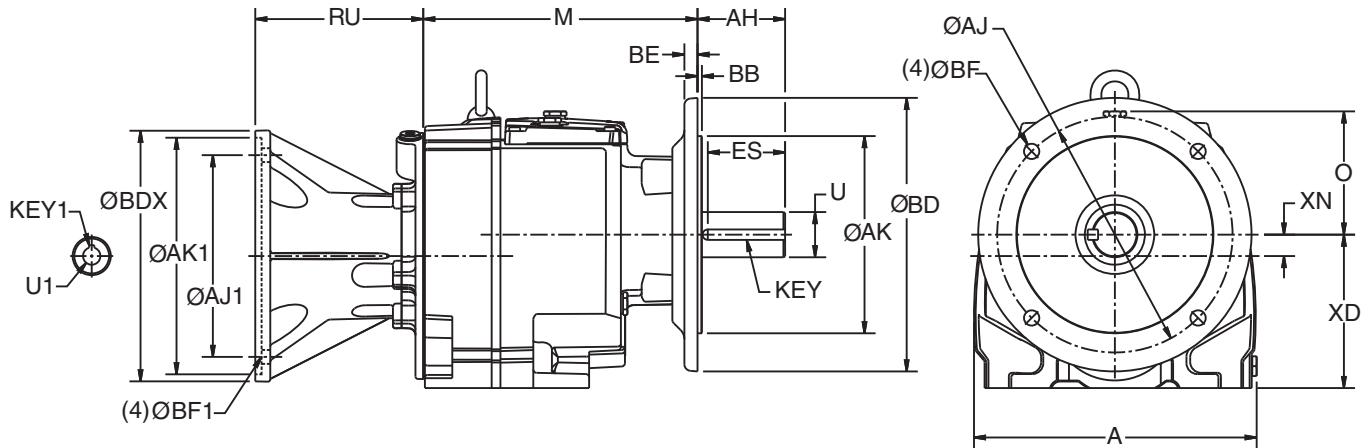

| Gear Frame | A | M | O | U ³ | AH | ES | XD | XN | Key |
|------------|-------|-------|------|----------------|------|------|------|------|---------|
| 35 | 14.19 | 12.40 | 5.98 | 2.375 | 4.72 | 4.19 | 8.86 | 1.14 | 5/8 Sq. |

| Flange Type | AK | AJ | BB | BD | BE | BF |
|-------------|-------|-------|------|-------|------|------|
| BS | 11.81 | 13.78 | 0.20 | 15.75 | 0.71 | 0.71 |
| BD1 | 9.84 | 11.81 | 0.20 | 13.78 | 0.71 | 0.71 |
| BD2 | 9.06 | 10.43 | 0.20 | 11.81 | 0.71 | 0.55 |

| Motor Frame | AJ1 | RU | BF1 | AK1 | BDX | U1 | Key1 |
|------------------------|--------|------|------|-------|-------|-------|----------|
| 56C | 5.875 | 4.14 | 0.44 | 4.50 | 6.50 | 0.625 | 3/16 Sq. |
| 143/145TC | 5.875 | 4.14 | 0.44 | 4.50 | 6.50 | 0.875 | 3/16 Sq. |
| 182/184TC | 7.250 | 5.87 | 0.57 | 8.50 | 9.00 | 1.125 | 1/4 Sq. |
| 213/215TC | 7.250 | 5.87 | 0.57 | 8.50 | 9.00 | 1.375 | 5/16 Sq. |
| 254/256TC | 7.250 | 7.09 | 0.57 | 8.50 | 9.00 | 1.625 | 3/8 Sq. |
| 284/286TC | 9.000 | 8.06 | 0.57 | 10.50 | 11.25 | 1.875 | 1/2 Sq. |
| 324/326TC ⁴ | 11.000 | 8.79 | 0.69 | 12.50 | 13.38 | 2.125 | 1/2 Sq. |

² All rough casting dimensions may vary by .25" due to casting variations.

³ Shaft extension tolerance: +.0000"; -.0005" up to 1.5" diameter inclusive. Larger diameters: +.000"; -.001".

⁴ Permitted in vertical mounting only.

Flange Mounted - Double/Triple Reduction

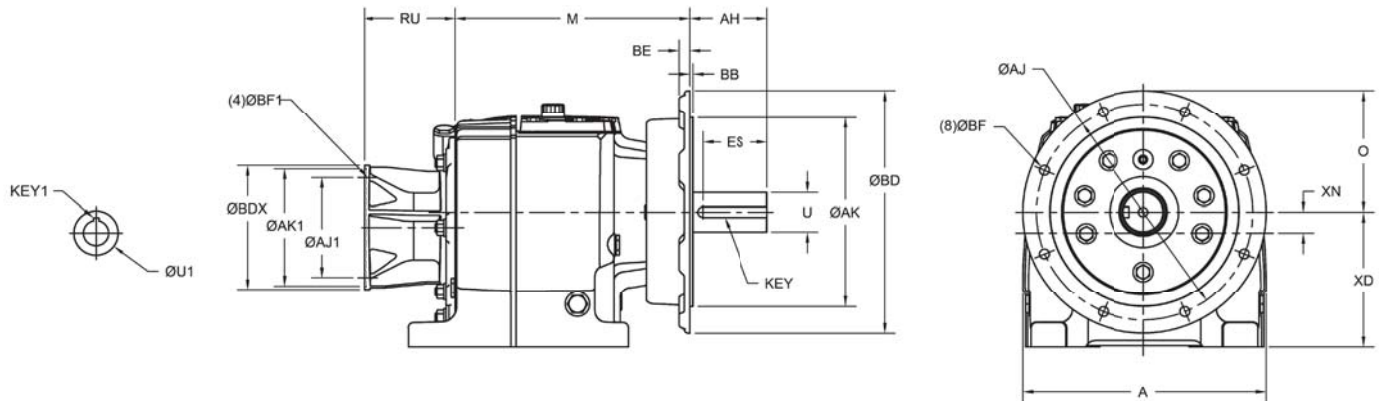

| Gear Frame | A | M | O | U ³ | AH | ES | XD ¹ | XN | Key |
|------------|-------|-------|------|----------------|------|-------|-----------------|-------|--------|
| 36 | 17.68 | 17.00 | 7.88 | 2.875 | 5.75 | 4.784 | 9.85 | 1.102 | 3/4 Sq |
| 37 | 20.39 | 19.69 | 8.00 | 3.625 | 7.00 | 5.893 | 12.40 | 2.362 | 7/8 Sq |
| 38 | 23.94 | 23.03 | 8.63 | 4.375 | 6.84 | 9.02 | 13.98 | 2.559 | 1 SQ |

| Gear Frame | Flange Type | AK | AJ | BB | BD | BE | BF |
|------------|-------------|--------|--------|-------|-------|------|------|
| 36 | BS | 17.717 | 19.685 | 0.236 | 21.65 | 0.79 | 0.70 |
| | BD1 | 13.780 | 15.748 | 0.236 | 17.70 | 0.79 | 0.70 |
| 37 | BS | 17.717 | 19.685 | 0.236 | 21.65 | 0.79 | 0.70 |
| | BD1 | 13.780 | 15.748 | 0.236 | 17.70 | 0.79 | 0.70 |
| 38 | BS | 21.65 | 23.62 | .197 | 25.98 | 0.79 | 0.87 |
| | BD1 | 17.72 | 19.69 | .197 | 21.65 | 0.79 | 0.69 |

| Motor Frame | Gear Frame | AJ | AK | BF | U1 | RU | BDX | Key1 |
|-------------|------------|-------|-------|------|-------|------|-------|----------|
| 145TC | 36 | 5.88 | 4.50 | .38 | .875 | 3.54 | 6.50 | 3/16 Sq. |
| 182TC-184TC | 36,37 | 7.25 | 8.50 | .50 | 1.125 | 5.26 | 9.00 | 1/4 Sq. |
| 213TC | 36,37 | 7.25 | 4.50 | .50 | 1.375 | 5.26 | 9.00 | 5/16 Sq. |
| 215TC | 38 | 7.25 | 4.50 | .50 | 1.375 | 6.12 | 9.00 | 5/16 Sq. |
| 254TC-256TC | All | 7.25 | 8.50 | .50 | 1.625 | 6.12 | 9.00 | 3/8 Sq. |
| 284TC-286TC | All | 9.00 | 10.50 | .50 | 1.875 | 7.09 | 9.00 | 1/2 Sq. |
| 324TC-326TC | All | 11.00 | 12.50 | .625 | 2.125 | 8.45 | 13.38 | 1/2 Sq. |
| 364TC-365TC | 37,38 | 11.00 | 12.50 | .625 | 2.375 | 8.45 | 13.38 | 5/8 Sq. |

¹ Dimension "D" will never be exceeded, but may vary from values shown. When exact dimensions are required, shims up to .03" may be necessary.

² All rough casting dimensions may vary by .25" due to casting variations.

³ Shaft extension tolerance: +.0000; -.001".

Flange Mounted - Combined Reduction

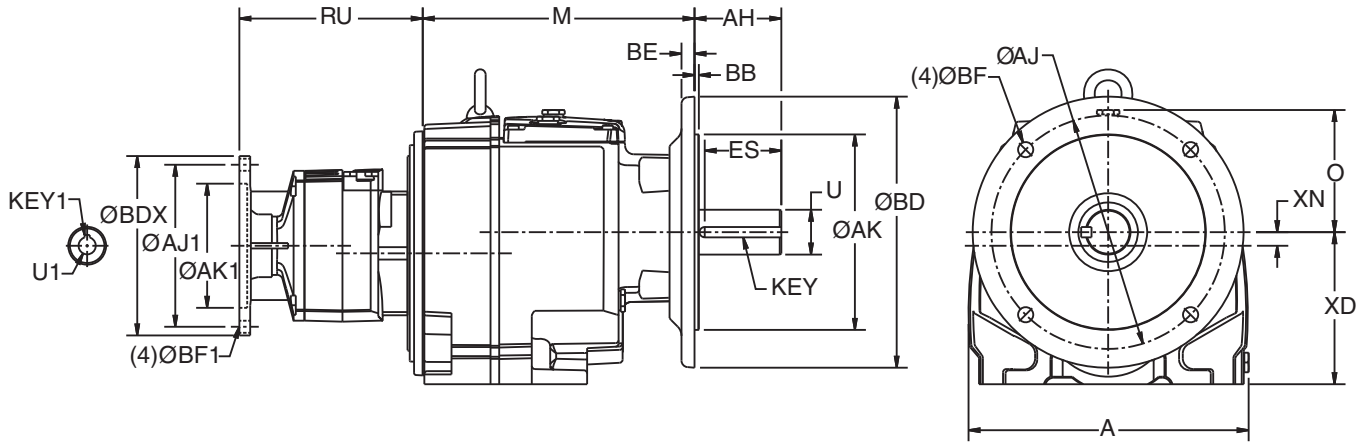

| Gear Frame | A | M | O | U ³ | AH | ES | XD | XN | Key |
|------------|-------|------|------|----------------|------|------|------|------|---------|
| 3254,3255 | 8.70 | 7.58 | 3.50 | 1.25 | 2.50 | 2.16 | 4.53 | 0.12 | 1/4 Sq. |
| 3374,3375 | 10.16 | 9.86 | 4.43 | 1.625 | 3.15 | 2.78 | 5.51 | 0.49 | 3/8 Sq. |

| Flange Type | 32 | | | | | | 33 | | | | | |
|-------------|------|------|------|------|------|------|------|-------|------|-------|------|------|
| | AK | AJ | BB | BD | BE | BF | AK | AJ | BB | BD | BE | BF |
| BS | 7.09 | 8.46 | 0.16 | 9.83 | 0.47 | 0.55 | 9.06 | 10.43 | 0.16 | 11.80 | 0.47 | 0.55 |
| BD1 | 5.12 | 6.50 | 0.14 | 7.87 | 0.39 | 0.47 | 7.09 | 8.46 | 0.16 | 9.83 | 0.47 | 0.55 |
| BD2 | 4.33 | 5.12 | 0.14 | 6.29 | 0.39 | 0.35 | 5.12 | 6.50 | 0.14 | 7.86 | 0.47 | 0.47 |

| Motor Frame | RU | AJ1 | BF1 | AK1 | BDX | U1 | Key1 |
|-------------|------|-------|------|------|------|-------|----------|
| 56C | 7.79 | 5.875 | 0.44 | 4.50 | 6.50 | 0.625 | 3/16 Sq. |
| 140TC | 7.79 | 5.875 | 0.44 | 4.50 | 6.50 | 0.875 | 3/16 Sq. |

² All rough casting dimensions may vary by .25" due to casting variations.

³ Shaft extension tolerance: +.0000"; -.0005" up to 1.5" diameter inclusive. Larger diameters: +.000"; -.001".