

# DUTY MASTER ALTERNATING CURRENT MOTORS

SQUIRREL-CAGE INDUCTION  
CAST IRON CONSTRUCTION

ENCLOSURE: TOTALLY ENCLOSED  
MOUNTING: FOOT

FRAMES 364T-365T

COOLING: FAN COOLED

617428-012

D

C

B

A

D

C

B

A

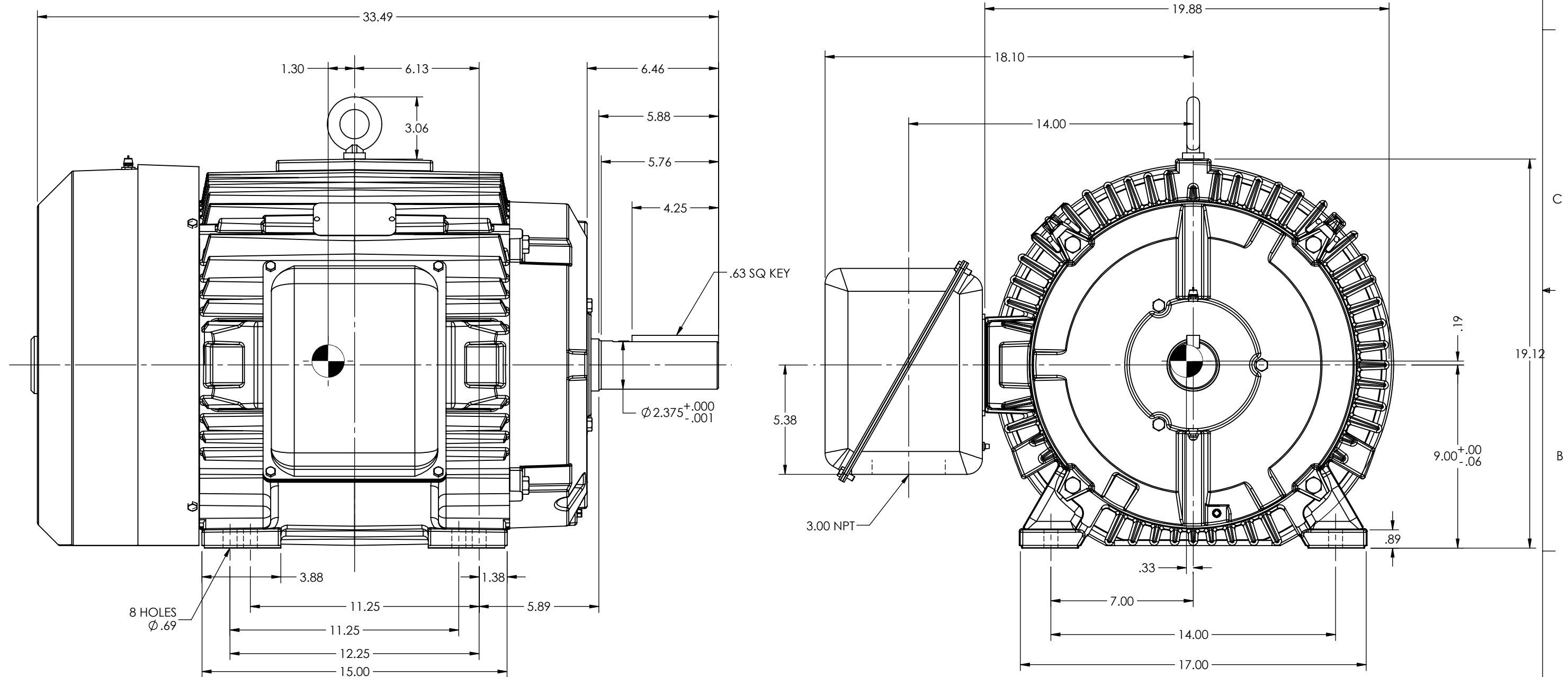

MAXIMUM PERMISSIBLE SHAFT RUNOUT WHEN MEASURED  
AT END OF STD. SHAFT EXTENSION IS .002 T.I.R. UP TO  
AND INCLUDING 1.625 DIA. AND .003 T.I.R. 1.625 DIA.  
TO 5 INCH DIA.

☉ - DENOTES CENTER OF GRAVITY WHICH MAY VARY  $\pm 1.00$  INCH

WEIGHT (LBS): 364T = 800  
365T = 840

MOTOR WEIGHTS MAY VARY BY 15% DEPENDING UPON RATING.

CUSTOMER IS RESPONSIBLE FOR DETERMINING THAT BALDOR'S PRODUCT WILL PERFORM SUITABLY IN THE INTENDED APPLICATION

REV. DESC: ADD CENTER OF GRAVITY			
REV: A	VERSION: 01	REVISED: 02:50:38 04/13/2017	TDR: 000001024374
MODEL NO. 617428-012			REF:
BY: USBRCHA2			<b>B</b>

**BALDOR**

DIM SHT TEFC 364-365T FT MTG W/GRSR AND RELIEF

617428-012

8 7 6 5 4 3 2 1