



Worm Gear Reducer Vertical High and Low Base Kit Installation Instructions

Power Transmission Solutions
Regal Beloit America, Inc.
7120 New Buffington Road
Florence, KY 41042
Application Engineering: 800 626 2093
www.RegalPTS.com

FORM
9173E
Revised
December 2015

⚠ WARNING

- Read and follow all instructions carefully.
- Disconnect and lock-out power before installation and maintenance. Working on or near energized equipment can result in severe injury or death.
- Do not operate equipment without guards in place. Exposed equipment can result in severe injury or death.

⚠ CAUTION

- Periodic inspections should be performed. Failure to perform proper maintenance can result in premature product failure and personal injury.



VERTICAL BASE KIT (HIGH OR LOW)

With the reducer on its side, output shaft vertical, align the base holes with the holes in the side of the reducer. Inset the bolts from the kit into the lockwashers. Thread into the housing holes and tighten to suggested tightening torque (see Table 1).

Unit Sizes 133-325 (Vertical Low)

- 1) Place reducer on a smooth level surface.
- 2) Align the clearance holes of one base plate with the tapped holes in the reducer housing.
- 3) Insert the four (4) of the supplied capscrews thru the clearance holes in the base into the threaded holes in the housing.
- 4) Tighten to the appropriate torque as shown in Table 1.
- 5) Flip reducer over making sure unit is stable.
- 6) Repeat steps 2-4.
- 7) Follow instructions supplied with the reducer for mounting assembled unit.

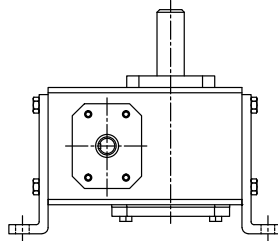

VERTICAL LOWBASE 262

Unit Sizes 375-600 (Vertical High and Low)

- 1) Place reducer on a smooth level surface.
- 2) Align the clearance holes of one base plate with the tapped holes in the reducer housing.
- 3) Insert the four (4) of the supplied capscrews thru the clearance holes in the base into the threaded holes in the housing.
- 4) Tighten to the appropriate torque as shown in Table 1.
- 5) Flip reducer over making sure unit is stable.
- 6) Repeat steps 2-4.
- 7) Follow instructions supplied with the reducer for mounting assembled unit.

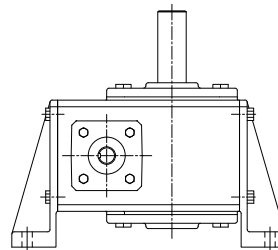

VERTICAL LOWBASE 375

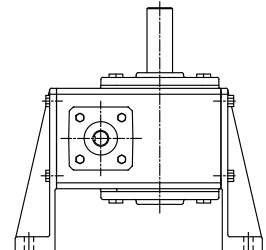

VERTICAL HIGHBASE 375

Unit Sizes 133-325 (Vertical High)

- 1) Place reducer on a smooth level surface.
- 2) Align the top clearance holes of one base plate with the tapped holes in the reducer housing.
- 3) Insert the two (2) of the supplied capscrews thru the clearance holes in the base into the threaded holes in the housing.
- 4) Tighten to the appropriate torque as shown in Table 1.
- 5) Flip reducer over making sure unit is stable.
- 6) Repeat steps 2-4.
- 7) Follow instructions supplied with the reducer for mounting assembled unit.

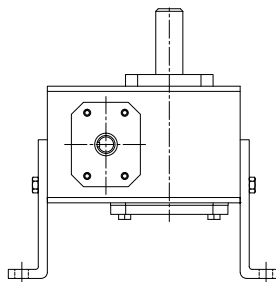

A Regal Brand

REGAL

www.regalbeloit.com