

LOAD RATINGS	
RATING	Lbs
RADIAL BASIC DYNAMIC	4,840
MAXIMUM STATIC CAPACITY	5,640

- NOTES:
1. BEARING IS PACKED WITH NLGI GRADE 2, LITHIUM BASED GREASE (UNLESS OTHERWISE SPECIFIED)
 2. ALL EXPOSED SURFACES HAVE BLACK OXIDE

MS NO.	NSN NO.	DRAWING NO.	CNB-52-B
--------	---------	-------------	----------

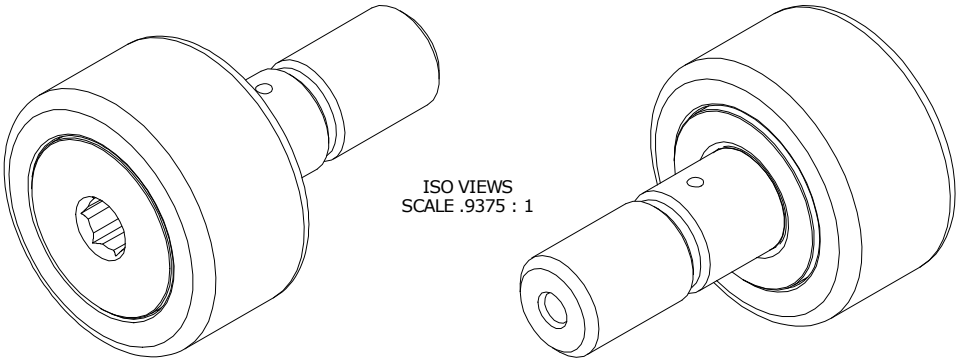

ISO VIEWS
SCALE .9375 : 1

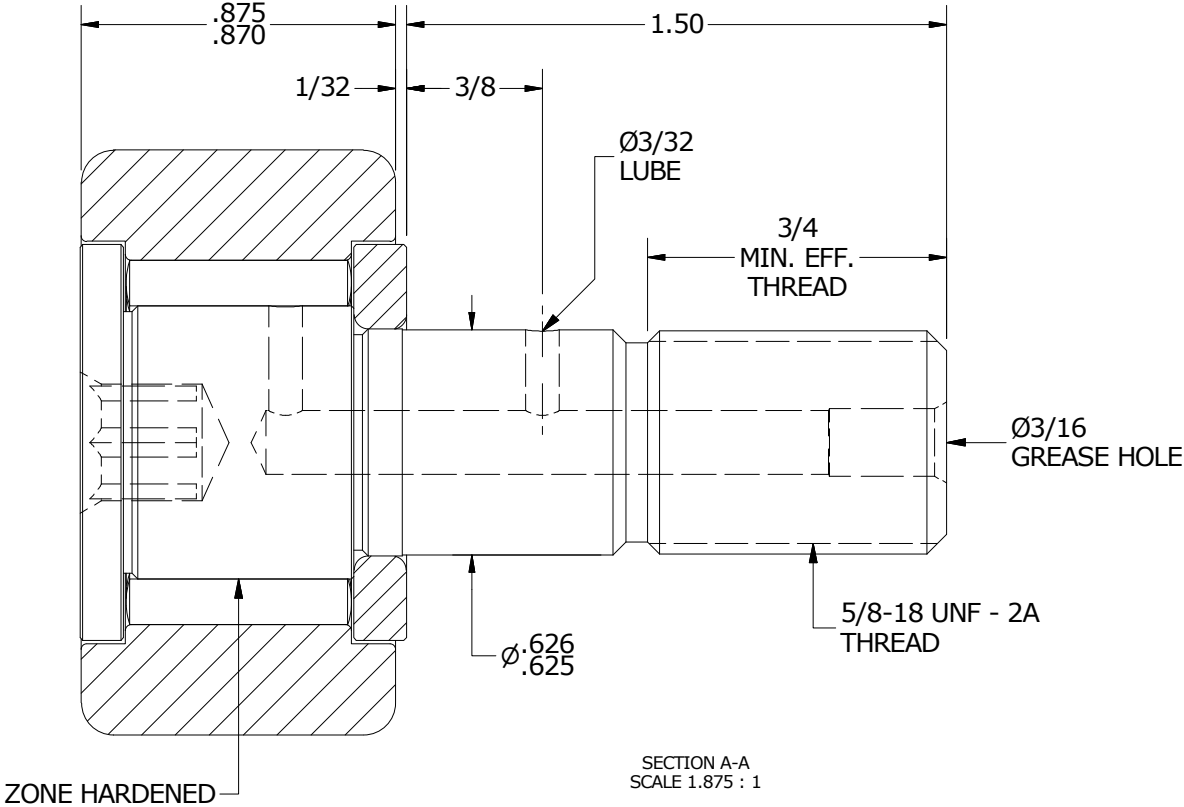
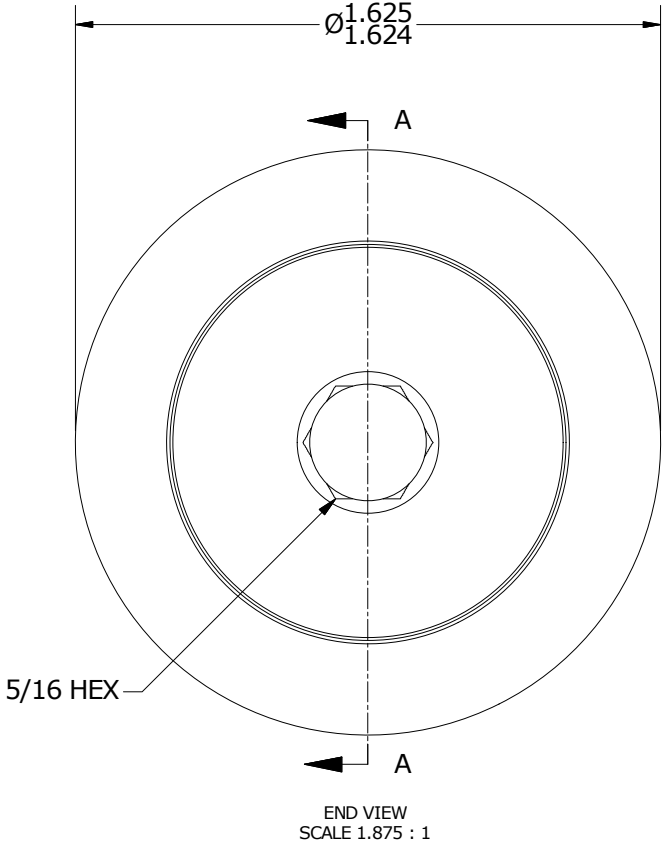

MATERIAL NOTES: OUTER RACE - BEARING STEEL, HEAT TREATED STUD - BEARING STEEL, ZONE HARDENED NEEDLE ROLLERS - BEARING STEEL, HEAT TREATED WASHER - COLD ROLLED STEEL, HEAT TREATED	CUSTOMER PART#	XX = ± .01 XXX = ± .005 XXXX = ± .0005 ANGLES = ± 1° INCH [METRIC] FRACTION = ± 1/32	CARTER MANUFACTURING IS NOT RESPONSIBLE FOR TYPOGRAPHICAL ERRORS		CARTER MANUFACTURING CO., INC. GRAND HAVEN, MICHIGAN 49417					
	ENGINEERING CHANGE ORDER NOTE		REVISION		PART NAME: ASSEMBLY					
			C	AUTHOR BY HG	DRAWN BY GJP	CHK'D BY SGW	SALES KR	MATERIAL NOTED		
			REVISION BY MD	DATE 1/6/2017	DATE 8/23/2000	DATE 1/6/2017	DATE 10/17/2010	SHEET 1 OF 2		