

Climax Metal Products Company

8141 Tyler Boulevard
Mentor, Ohio 44060
USA

Toll free: 800-542-6552

Phone: 440-585-0300

Fax: 800-860-5553

Email: sales@climaxmetal.com

Website: www.climaxmetal.com

ITEM # 2ISCC050-037SKW, TWO-PIECE INDUSTRY STANDARD CLAMPING COUPLINGS W/KEYWAY 2ISCC-SERIES

Stainless Steel Two-Piece Industry Standard Clamping Coupling with Keyway. High axial load & torque capacity. Does not mar the shaft.



[Drawing](#) | [Specifications](#) |

Drawing

Dimensional Drawing

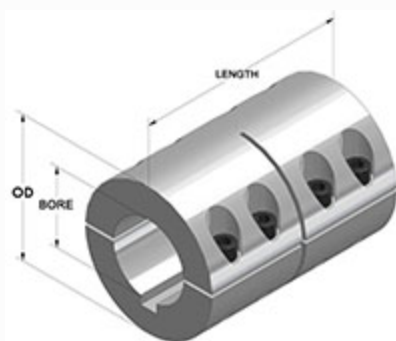

Two-Piece Industry Standard Clamping Coupling with Keyway

Specifications

Bore	1/2 in
2nd Bore	3/8 in
OD	1 1/8 in
Length	1 3/4 in
Style	Two-Piece Clamp
Keyway Size	1/8 x 1/16 in
Material	Stainless Steel, ASTM A582
Finish	Plain
Clamp Screw	Hex Socket Cap Screw, 3A Thread, Stainless Steel, ASTM F837: 8-32 x 1/2
Recessed Screw	No
Approximate Weight	5.70 oz
UPC Code	044861061824
Downloads	Catalog Page

Competitor Part Number

Alternate Part Number	2338105 2APU3 3739074 60845K72 75242149 SPC86SS SPC-8-6-SS
------------------------------	--