

# DUTY MASTER ALTERNATING CURRENT MOTORS

SQUIRREL-CAGE INDUCTION  
CAST IRON CONSTRUCTION

FRAMES 364TC-365TC

COOLING: FAN COOLED

841-XL

ENCLOSURE: TOTALLY ENCLOSED  
MOUNTING: FOOT

617428-132

D

C

B

A

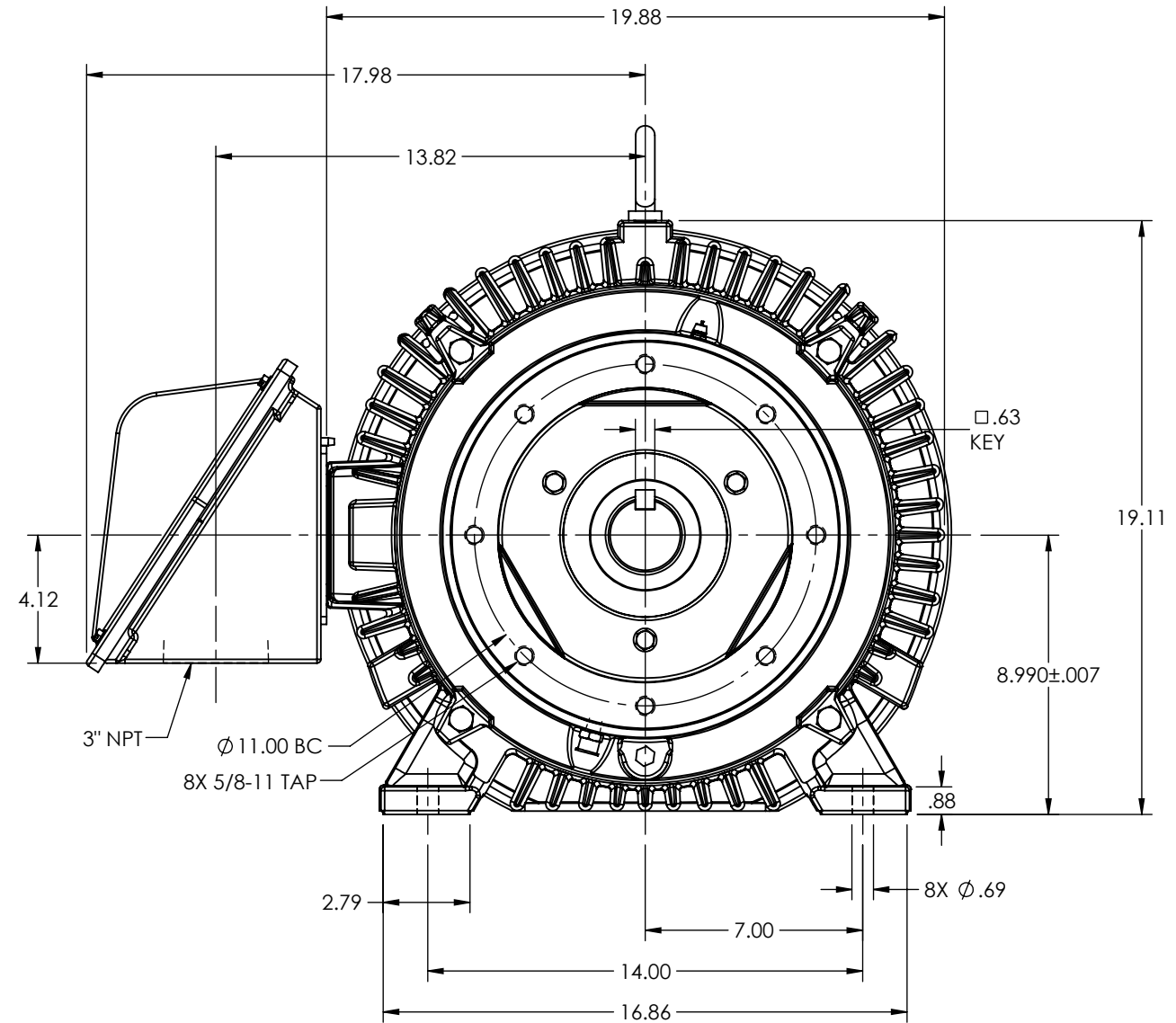
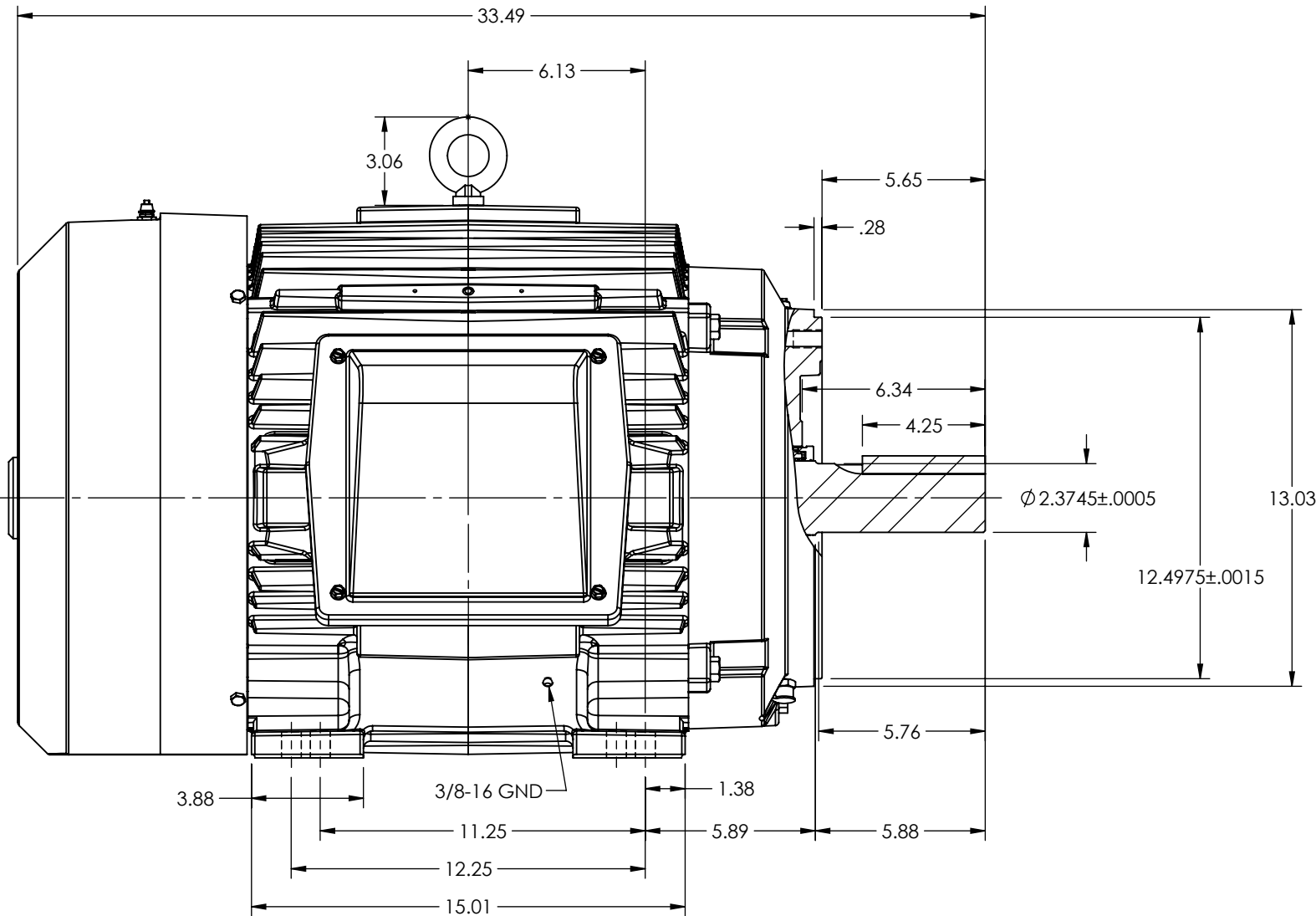

D

C

B

A

MAXIMUM PERMISSIBLE SHAFT RUNOUT WHEN MEASURED AT END OF SHAFT EXTENSION IS .0015 T.I.R.

WEIGHT (LBS): 364TC = 880  
365TC = 905

MOTOR WEIGHTS MAY VARY BY 15% DEPENDING UPON RATING.

CUSTOMER IS RESPONSIBLE FOR DETERMINING THAT BALDOR'S PRODUCT WILL PERFORM SUITABLY IN THE INTENDED APPLICATION

REV. DESC: CHANGE T.I.R.			
REV: A	VERSION: 01	REVISED: 06:58:53 01/18/2018	TDR: 000001057593
MODEL NO. 617428-132			REF: -
BY: RAGEC			<b>B</b>

## BALDOR

DIM SHT TEFC 364-5TC 841-XL W/ STD C BOX FT MTG (611760-571)

617428-132

8 7 6 5 4 3 2 1