

TOOL REST IN SHIPPING POSITION

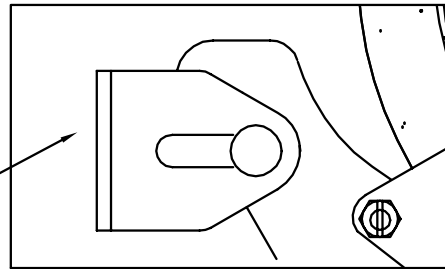

CUSTOMER IS RESPONSIBLE FOR DETERMINING THAT MOTOR PERFORMANCE IS SUITABLE IN THE APPLICATION.

|   |        |                              |               |
|---|--------|------------------------------|---------------|
| REV. DESC: CHG'D HA2040A01 TO HA2072; DIM 15.08 WAS 15.28 |        |                              |               |
| REV. LTR: F   | BY: RT | REVISED: 11:00:24 03/11/2004 | TDR: 326808   |
| 1750279   |        | FILE: AAA00045822            | REF: G7LY0371 |
|   |        | MTL: -                       |               |

**BALDOR ELECTRIC Co.**

7' UTILITY GRINDER NON-EXHAUST TYPE 420C 115 VOLTS