

PRODUCT INFORMATION PACKET



Model No: CZ6T17WC58A

Catalog No: 119499.00

119499.00..2HP..1745RPM.56C.TEFC.230/460V.3PH.60HZ.CONT.40C.1.15SF.C
FACE.CZ6T17WC58.....WASHDOWN MOTORS.T-STATS.....

3 Phase



Regal and Leeson are trademarks of Regal Beloit Corporation or one of its affiliated companies.

©2018 Regal Beloit Corporation, All Rights Reserved. MC017097E





Nameplate Specifications

| | | | |
|----------------------------|-----------------------------|------------------------|---------------|
| Output HP | 2 Hp | Output KW | 1.5 kW |
| Frequency | 60 Hz | Voltage | 208-230/460 V |
| Current | 6.0-5.8/2.9 A | Speed | 1745 rpm |
| Service Factor | 1.15 | Phase | 3 |
| Efficiency | 86.5 % | Duty | Continuous |
| Insulation Class | F | Design Code | B |
| KVA Code | L | Frame | 56C |
| Enclosure | Totally Enclosed Fan Cooled | Overload Protector | No |
| Ambient Temperature | 40 °C | Drive End Bearing Size | 6205 |
| Opp Drive End Bearing Size | 6205 | UL | Recognized |
| CSA | Y | CE | Y |
| IP Code | 56 | | |

Technical Specifications

| | | | |
|-----------------------|------------------------------|-----------------------|------------------|
| Electrical Type | Squirrel Cage Inverter Rated | Starting Method | Line Or Inverter |
| Poles | 4 | Rotation | Reversible |
| Mounting | Round | Motor Orientation | HORIZONTAL |
| Drive End Bearing | BALL | Opp Drive End Bearing | BALL |
| Frame Material | Stainless Steel | Shaft Type | NEMA 56 |
| Overall Length | 13.19 in | Frame Length | 8.25 in |
| Shaft Diameter | 0.625 in | Shaft Extension | 1.88 in |
| Assembly/Box Mounting | F1 ONLY | | |
| Outline Drawing | 028943-825 | Connection Diagram | 005010.20 |

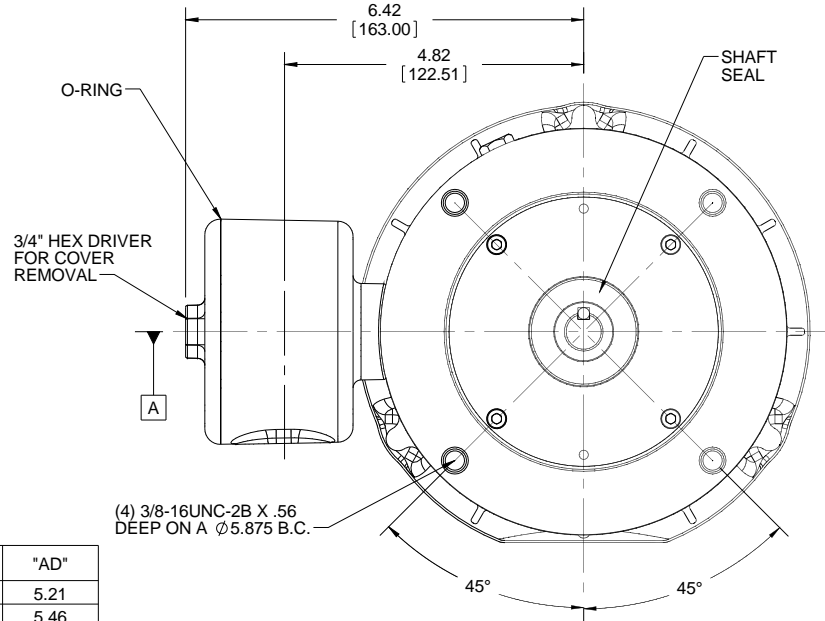
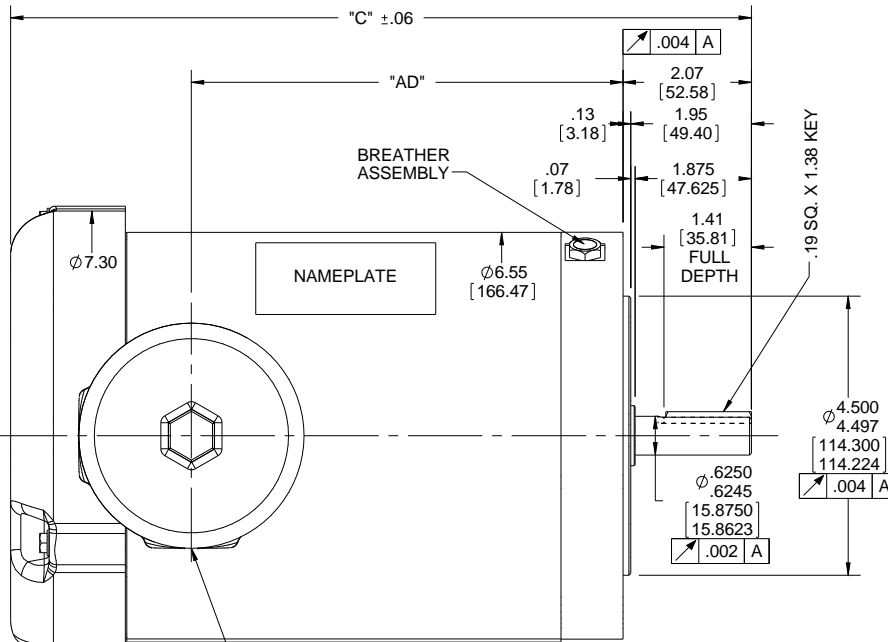

| DASH NO. | "C" | "AD" |
|----------|-------|------|
| 525 | 10.19 | 5.21 |
| 550 | 10.44 | 5.46 |
| 575 | 10.69 | 5.71 |
| 600 | 10.94 | 5.96 |
| 625 | 11.19 | 6.21 |
| 650 | 11.44 | 6.46 |
| 675 | 11.69 | 6.71 |
| 700 | 11.94 | 6.96 |
| 725 | 12.19 | 7.21 |
| 750 | 12.44 | 7.46 |
| 775 | 12.69 | 7.71 |
| 800 | 12.94 | 7.96 |
| 825 | 13.19 | 8.21 |
| 850 | 13.44 | 8.46 |

1/2-14 NPT CONDUIT HOLE

| | | |
|---|-------------------|------------------|
| DRAWING REVISION D | REVISION BY AS | DATE 10/26/16 |
| ECO ECO-0111918 | APPROVED BY JD | DATE 10/26/16 |
| ECO DESCRIPTION ADDED ITEM #825 | | |
| <small>COPYRIGHT REGAL BELOIT AMERICA, INC. ALL RIGHTS RESERVED. PROPRIETARY AND CONFIDENTIAL INFORMATION - THIS DOCUMENT IS THE PROPERTY OF REGAL BELOIT AMERICA, INC. (OWNER) AND CONTAINS OWNER'S PROPRIETARY INFORMATION. ANY PERSON, CORPORATION OR OTHER FIRM RECEIVING IT IS DEEMED, BY RECEIVING IT, TO AGREE THAT IT, AND/OR ANY PART OF IT, SHALL NOT BE DISCLOSED TO ANY PERSON, CORPORATION OR OTHER ENTITY, DUPLICATED, AND/OR USED, EXCEPT AS EXPRESSLY APPROVED IN WRITING IN ADVANCE BY OWNER. THIS DOCUMENT SHALL BE RETURNED TO OWNER UPON REQUEST. IT MAY BE SUBJECT TO CERTAIN RESTRICTIONS UNDER APPLICABLE EXPORT CONTROL LAWS AND REGULATIONS.</small> | | |

| | | | |
|--|---------|-----------|-------|
| TOLERANCES UNLESS OTHERWISE SPECIFIED: | | | |
| DEC. | INCH | mm | ANGLE |
| .X | ±0.1 | [±2.5] | ±0.5° |
| .XX | ±0.01 | [±0.25] | |
| .XXX | ±0.005 | [±0.127] | |
| .XXXX | ±0.0005 | [±0.0127] | |
| REMOVE BURRS & BREAK SHARP | | | |
| EDGES: .003/.015 [.076/.381] X 45° | | | |
| CORNER FILLETS: R.02 [.51] | | | |
| MACHINED SURFACES: 125/3.2 | | | |
| mm SHOWN IN [BRACKETS] | | | |

| |
|------------------------|
| DRAWN BY LST 1/9/09 |
| DATE |
| APPROVED BY |
| DATE |
| REFERENCE |
| THIRD ANGLE PROJECTION |

REGAL™ Regal Beloit America, Inc.

DESCRIPTION: **OUTLINE**
TEFC "C" FACE

MATERIAL: _____ PROCESS/FINISH: _____

SIZE: **B** DRAWING NUMBER: **028943** SHEET: **1 OF 1**

VIEW FROM OUTSIDE OF MOTOR AT SWITCH END. Uncontrolled Copy

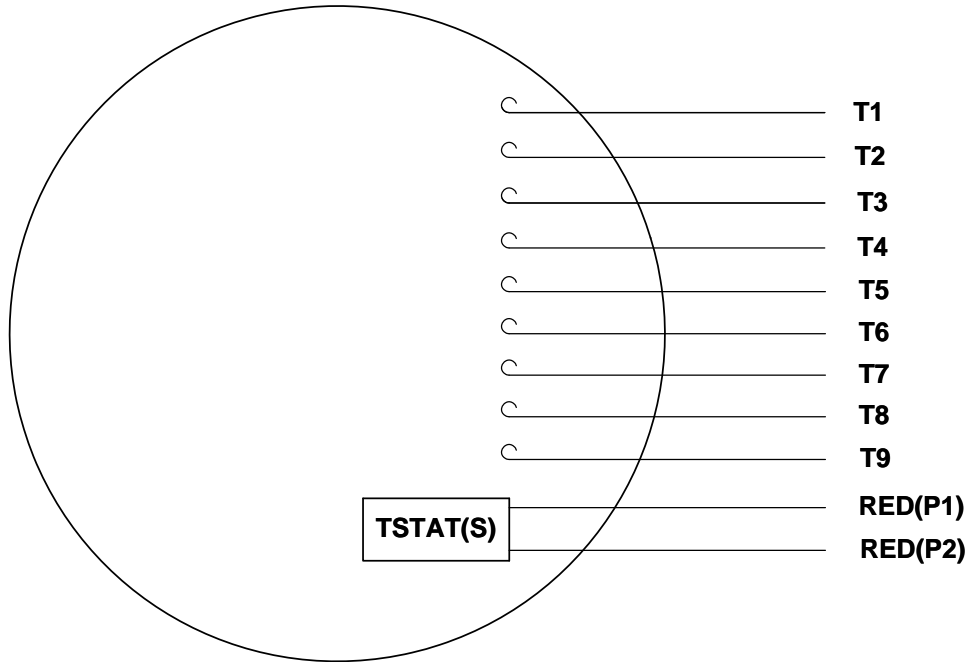

LINE LEADS

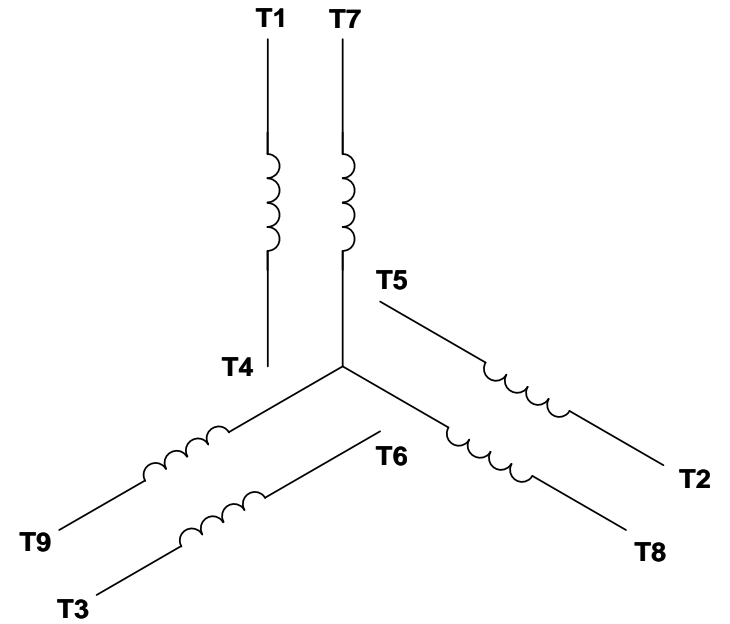

| VOLTAGE | L1 | L2 | L3 | JOIN & INSULATE |
|---------|-------|-------|-------|-------------------------------|
| HIGH | T1 | T2 | T3 | (T4,T7) (T5,T8) (T6,T9) |
| LOW | T1,T7 | T2,T8 | T3,T9 | T4,T5,T6 |

DRAWING REVISION **G** REVISION BY **MVG** DATE **04/05/2017**

ECO **ECO-0121253** APPROVED BY **SM** DATE **04/05/2017**

ECO DESCRIPTION
ADDED P1 & P2 FOR TSTAT

COPYRIGHT REGAL BELOIT AMERICA, INC. ALL RIGHTS RESERVED.
PROPRIETARY AND CONFIDENTIAL INFORMATION - THIS DOCUMENT IS THE PROPERTY OF
REGAL BELOIT AMERICA, INC. ('OWNER') AND CONTAINS OWNER'S PROPRIETARY
INFORMATION. ANY PERSON, CORPORATION OR OTHER FIRM RECEIVING IT IS DEEMED,
BY RECEIVING IT, TO AGREE THAT IT, AND/OR ANY PART OF IT, SHALL NOT BE DISCLOSED
TO ANY PERSON, CORPORATION OR OTHER ENTITY, DUPLICATED, AND/OR USED, EXCEPT
AS EXPRESSLY APPROVED IN WRITING IN ADVANCE BY OWNER. THIS DOCUMENT SHALL
BE RETURNED TO OWNER UPON REQUEST. IT MAY BE SUBJECT TO CERTAIN
RESTRICTIONS UNDER APPLICABLE EXPORT CONTROL LAWS AND REGULATIONS.

TOLERANCES UNLESS OTHERWISE SPECIFIED:

| DEC. | INCH | mm | ANGLE |
|-------|---------|-----------|-------|
| .X | ±0.1 | [±2.5] | ±0.5° |
| .XX | ±0.01 | [±0.25] | |
| .XXX | ±0.005 | [±0.127] | |
| .XXXX | ±0.0005 | [±0.0127] | |

REMOVE BURRS & BREAK SHARP EDGES: .003/.015 [.076/.381] X 45°
CORNER FILLETS: R.02 [.51]
MACHINED SURFACES: 125/3.2 INCH/mm
mm SHOWN IN [BRACKETS]

DRAWN BY **DBT 12/16/97**

DATE

APPROVED BY **KH 12/17/97**

DATE

REFERENCE

THIRD ANGLE PROJECTION

REGAL™ Regal Beloit America, Inc.

DESCRIPTION
CONN DIAGRAM-EXTERNAL
3 PHASE WITH PROTECTOR

| | |
|--|-----------------------------------|
| MATERIAL DECAL - 004014 (TSTAT) - 080582 | PROCESS/FINISH STOCK |
| SIZE A | DRAWING NUMBER 00501020 |
| SHEET 1 OF 1 | |



Motor Load Data

| Load | 0% | 25% | 50% | 75% | 100% | 115% | 125% | LR |
|----------------|------|------|------|------|------|-------|------|------|
| Current (Amps) | 1.70 | 1.92 | 2.19 | 2.58 | 2.90 | 3.2 | 3.5 | 26.5 |
| Torque (ft-lb) | 0.00 | 1.50 | 3.0 | 4.5 | 6.0 | 6.5 | 7.5 | 18.8 |
| HPM | 1800 | 1787 | 1774 | 1763 | 1751 | 1,730 | 1732 | 0 |
| Efficiency (%) | | 74.5 | 83.4 | 85.6 | 86.5 | 85.5 | 85.6 | |
| P.F. (%) | 7.1 | 33.4 | 51.9 | 64.0 | 75.6 | 76.0 | 77.3 | 42.0 |

Motor Speed Data

| | LR | Pull-Up | BD | Rated | Idle |
|----------------|------|---------|------|-------|------|
| Speed (RPM) | 0 | 775 | 1085 | 1751 | 1800 |
| Current (Amps) | 26.5 | 24.4 | 14.2 | 2.90 | 1.70 |
| Torque (ft-lb) | 18.8 | 15.0 | 24.6 | 6.0 | 0.00 |

Information Block

| | | | | |
|-----------------------------|-------------------------|--------|--------|--------|
| HP | 2.0 | | | |
| Sync. RPM | 1800 | | | |
| Frame | 140 | | | |
| Enclosure | TEFC | | | |
| Construction | TFR | | | |
| Voltage | 208-230/460#190/380 V | | | |
| Frequency | 60 Hz | | | |
| Design | A | | | |
| LR Code letter | L | | | |
| Service Factor | 1.15 | | | |
| Temp Rise @ FL | 53 °C | | | |
| Duty | CONT | | | |
| Ambient | 40 °C | | | |
| Elevation | 1,000 feet | | | |
| Rotor/Shaft wk ² | 0.16 lb-Ft ² | | | |
| Ref Wdg | T634340 FR | | | |
| Sound Pressure @ 1M | 65 dBA | | | |
| VFD Rating | CONSTANT 6:1 | | | |
| Outline Dwg | 028943-825 | | | |
| Conn. Diag | 005010.20 | | | |
| Additional Specifications: | | | | |
| 0 | | | | |
| EQUIV CKT (OHMS / PHASE) | | | | |
| R1 | R2 | X1 | X2 | Xm |
| 0.0000 | 0.0000 | 0.0000 | 0.0000 | 0.0000 |

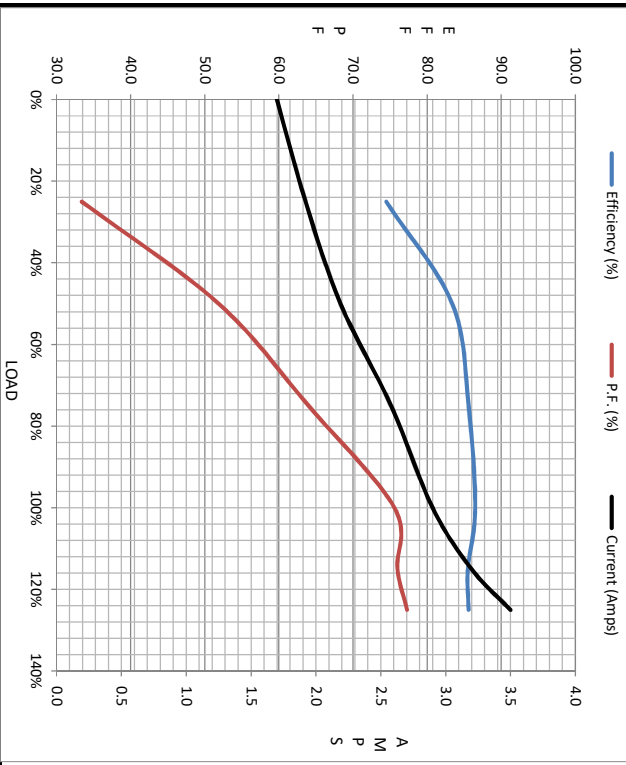

Speed - Torque Curve

