



Hammond Power Solutions Inc.

TITLE: IRON CORE LINE REACTOR
NAMEPLATE INFORMATION

DES:	ASETH		
DATE:	14/07/22		
SCALE:	NTS		
NO.	DATE	BY	REVISION

SHEET 1 OF 2

EDBCRX0077BE

0.3 jwen 2023/01/31 11:58



Hammond
Power Solutions

HPS CENTURION R
THREE PHASE LINE REACTOR
P/N CRX0077BE

INDUCT. 0.36 MH 50/60 HZ 77 AMPS
0.6 KV CLASS WT: 35 lbs ENCL. TYPE 1/IP20
AMBIENT: 50° TEMP CLASS: 180 TYPE JR-2A

USE WITH SUITABLY RATED LISTED (ZMVV) LUGS
WINDING TERMINAL TEMPERATURE: 75° C



LR3902



LISTED

MADE IN CANADA
f003783e

IND.
CONT.
EQ.
E61431

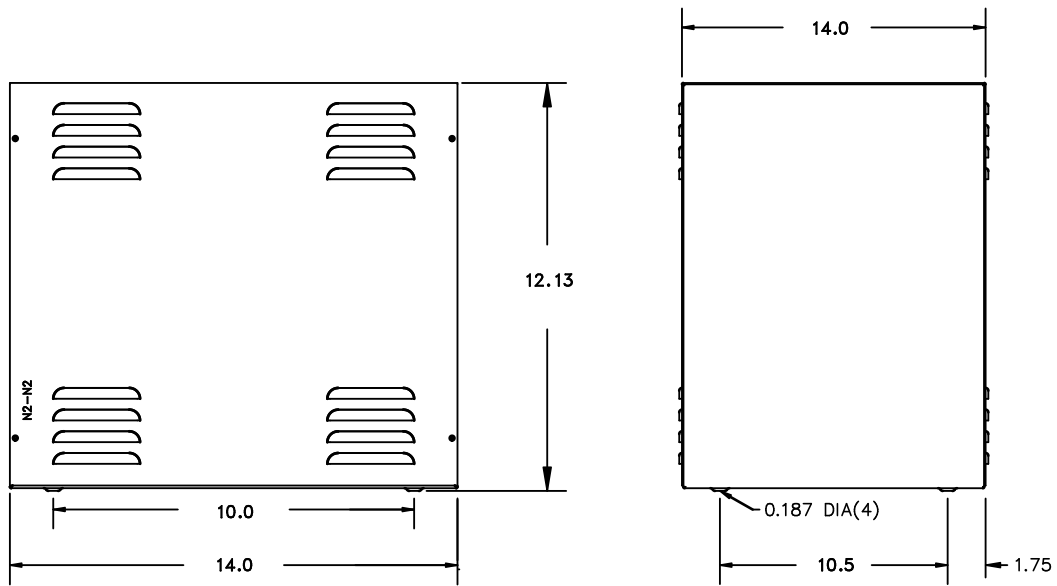

All Dimensions in inches

ENCLOSURE COLOR :ASA 61 GREY

IN TERMINAL DETAIL

OUT TERMINAL DETAIL

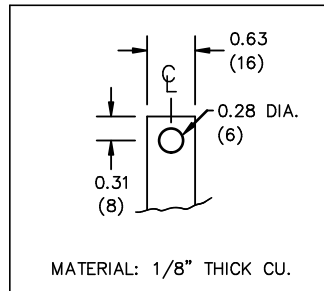
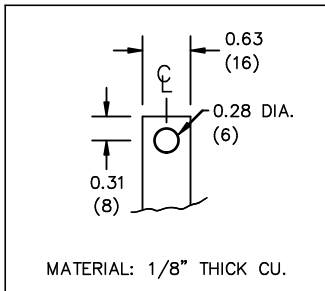

CUSTOMER NOTES:

- IN TERMINATED AT BOTTOM FRONT
- OUT TERMINATED AT TOP FRONT



TITLE: IRON CORE LINE REACTOR				
DES: ASETH				
DATE: 14/07/22				
SCALE: NTS				
NO.	DATE	BY	REVISION	

SHEET 2 OF 2

EDBCRX0077BE